

High Airflow in Compact Size for Horizontal Installation

Upgrade Path

To upgrade, consider the Donaldson EPG air cleaner or PSD air cleaners that use newer filtration technologies.

Applications

- Airflow range 775 to 1600 cfm airflow throughput per air cleaner
- Horizontal installation, side inlet
- Over-highway trucks: horizontal under hood or behind cab
- Buses: under hood

Air Cleaner Features

- Relatively small air cleaner with high airflow
- Designed for horizontal installation with side inlet
- Housing is metal and coated with a corrosion and chemical resistant polymer paint
- Direct engine mounting is not recommended due to excessive engine vibration.
- All models have service access cover opposite the outlet end of the air cleaner

Filter Features

- Cone shaped filters, which we call Konepac, allow maximum media in a small package (one filter is shipped with each air cleaner)
- Other filter performance options available (see service parts lists for specifics)



LIGHT DUST

This ECG Konepac model is mounted to the fire-wall on this on-highway truck. The latched service cover allows for easy access to the filter for change out.



ECG Konepac I with Latched Service Access
Left: a standard media filter, which is available with either standard or carbon-resistant media. Middle: the ECG Konepac™ metal air cleaner housing. Right: a extended service filter



ECG Konepac I with Perforated Inlet - an alternative to disposable style housings. You'll get the economy of replacing the filter instead of the entire unit each time. The perforated inlet on the side of this G112417 housing (middle) is the same as the disposable's, so conversion is direct and easy. Left: Extended service filter. Right: Filter designed for scheduled maintenance.

When spec'ing an Air Cleaner . . .

Service parts for this axial style air cleaner may not be available due to newer filtration technology and housing designs. Donaldson now recommends one of two other families - the EPG or PSD.

Initial Airflow Restriction

CFM @ "H2O			Air Cleaner Model
6"	8"	10"	
MODELS WITH BOLTED SERVICE ACCESS			
775	880	1000	G092001
1100	1300	1425	G112001
1200	1400	1550	G132000
MODELS WITH LATCHED SERVICE ACCESS			
800	925	1040	G092401
1200	1400	1600	G112404
1200	1400	1600	G112417 ¹
1200	1400	1600	G112501
1200	1400	1600	G112504

1 - No inlet tube, perforated inlet holes on side

Airflow Pattern "G"

Air in the side, out the end

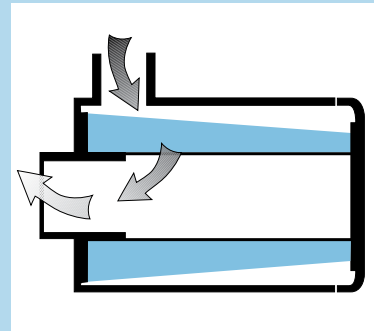

ECG Konepac™ Specification Illustrations

Bolted Service Access

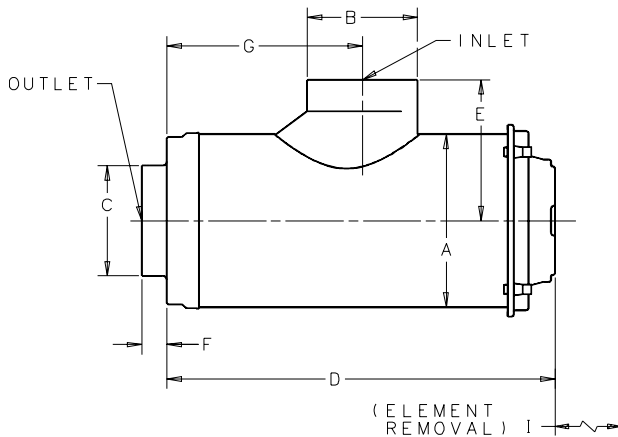

Latched Service Access

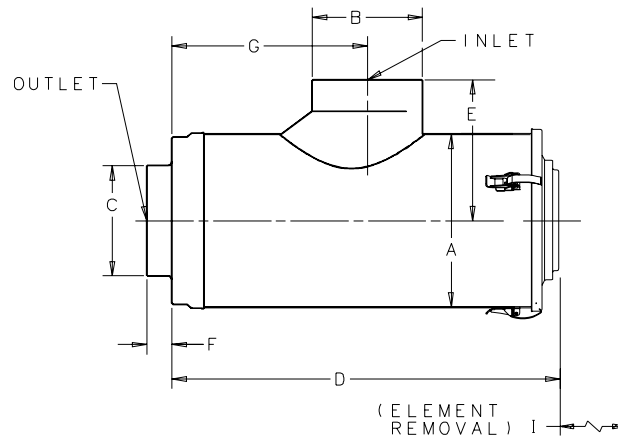

ECG Konepac Specifications

Air Cleaner Models	Body Diameter (A)		Inlet Diameter (B)		Outlet Diameter (C)		Overall Length (D)		(E)		Inlet Length (F)		(G)		Service Clearance		Service Indicator Tap	Weight	
	in	mm	in	mm	in	mm	in	mm	in	mm	in	mm	in	mm	in	mm		lbs	kg
BOLTED SERVICE ACCESS																			
G092001	9.00	229	6.00	152	6.00	152	28.63	727	7.85	199	1.18	30	18.63	473	27.62	702	No	30	14
G112001	11.00	279	7.00	178	7.00	178	28.62	727	8.95	227	1.58	40	20.62	524	27.00	686	No	38	17
G132000	13.00	330	7.00	178	7.00	178	24.59	625	9.54	242	2.38	60	18.25	464	27.62	702	No	36	16
LATCHED SERVICE ACCESS																			
G092401	9.00	229	6.00	152	6.00	152	28.70	729	7.86	200	1.18	30	21.75	553	27.62	702	No	30	14
G112404	11.00	279	7.00	178	7.00	178	22.70	577	8.97	228	2.00	51	12.32	313	22.00	559	Yes	33	15
G112417 ¹	11.00	279	--	--	7.00	178	28.70	729	--	--	2.00	51	15.11	384	28.00	711	Yes	30	14
G112501	11.00	279	7.00	178	7.00	178	28.30	719	8.97	228	2.00	51	21.22	539	28.00	711	Yes	23	10
G112504	11.00	279	7.00	178	7.00	178	22.30	566	8.97	228	2.00	51	12.32	313	22.00	559	Yes	20	9

1 - This model has no inlet tube; inlet consists of rectangular perforated holes on side of housing.

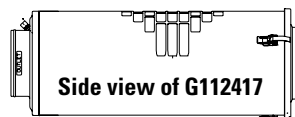

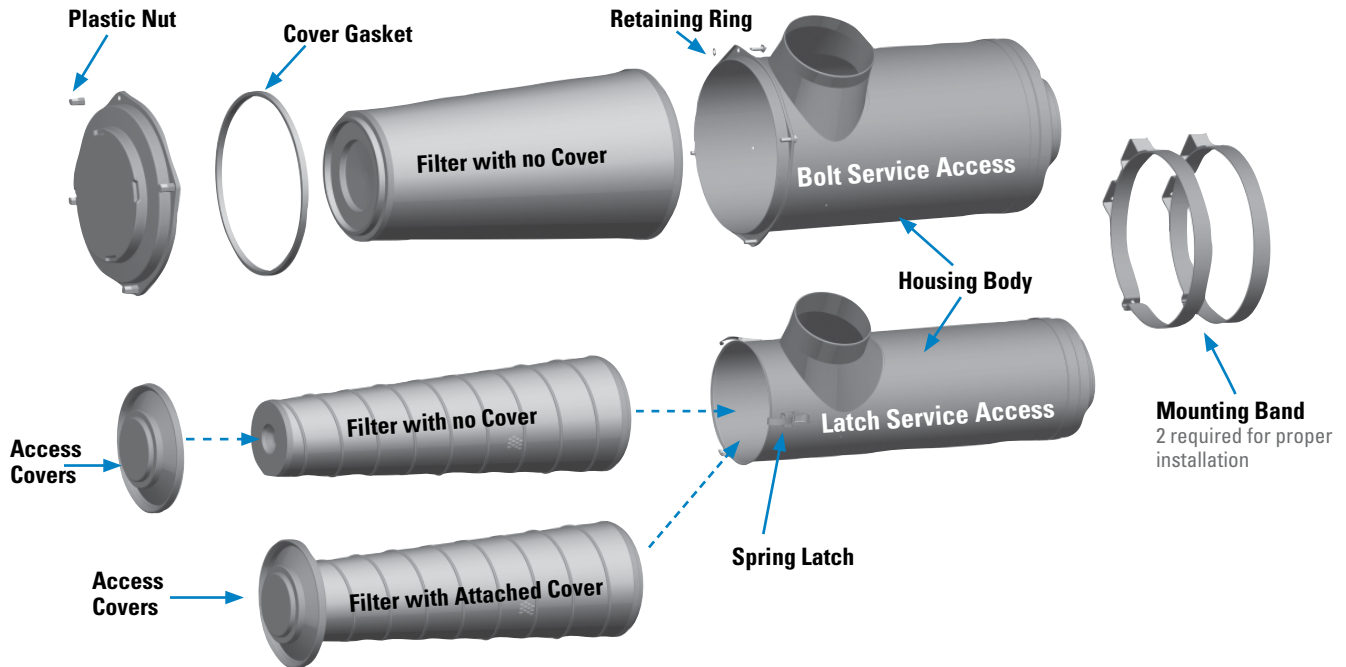

LIGHT DUST

ECG Konepac Service Parts

G092001 Bolted Cover	
filter, primary, no cover, treated.....	P1480441,3
mounting band.....	P0040732
nuts, plastic.....	P119325
retaining ring.....	P129469

G092401 Latched Cover	
filter, primary, no cover	P1506923
filter, primary, no cover, treated.....	P1480441
filter, primary, attached cover.....	P1506936
latch replacement kit.....	X009291

G112001 Bolted Cover	
filter, primary, no cover, treated.....	P1480431,3
gasket, cover	P155211
mounting band.....	P0040792
nuts, plastic.....	P119325
retaining ring.....	P129469

G112404 Latched Cover	
cover	P150862
filter, primary, attached cover	- ES & HE
filter, primary, attached cover.....	P153551
filter, primary, no cover, treated.....	P154575 ...1,3,5
gasket, cover	P536493
latch replacement kit	X009291

G112417 Latched Cover	
cover	P150862
filter, primary, no cover	P1506943,5
filter, primary, no cover-ES & HE ..	EAF5029.....5
filter, primary, attached cover.....	P150695
filter, primary, attached cover	- ES & HE
gasket, cover	P536493
latch replacement kit	X009291

G112501 Latched Cover	
filter, primary.....	P1506945
filter, primary, no cover-ES & HE..	EAF5029.....5
filter, primary.....	P1506953,6
filter, primary, attached cover	- ES & HE
filter, primary, treated	P1480431
gasket, cover	P536493
latch replacement kit	X009291

G112504 Latched Cover	
cover	P150862
filter, primary, attached cover	- ES & HE
filter, primary, attached cover.....	P1535516
filter, primary, attached black	cover
filter, primary, no cover, treated.....	P1545751,5
gasket, cover	P536493
latch replacement kit	X009291

G132000 Bolted Cover	
filter, primary, no cover	P1421003
filter, primary, no cover-ES & HE..	EAF5027
gasket, cover	P120604
mounting band.....	P0137222
nuts, plastic.....	P119325
retaining ring.....	P129469



ECG style air cleaners have three cover latches that need to perform correctly to ensure the filter gasket is sealing properly. These latches should be checked for tightness and wear. To check for tightness, close all three latches, then open and close them one at a time. There should be good tension and should snap tightly when closed. If any latches seem loose or rattle, they should be replaced.

NOTES:
 1 = Filter is treated with chemical for carbon resistance and is not cleanable
 2 = Two required for proper installation
 3 = Shipped with air cleaner initially
 5 = Also requires access cover P150862
 6 = Access cover is attached to filter
 ES = Extended Service
 HE = High Efficiency