

Designed for the Worst Dust Conditions New Choice for Construction and Off-Highway Applications

The SSG Air Cleaner offers design improvements over our older SRG air cleaner style.

Design Improvements

The SSG Air Cleaner has filters that use radial seal sealing technology, compared to axial seal style filters.



This single design improvement eliminates the need to replace filter and cover gaskets -- less service time and fewer parts to inventory.

Another new design improvement - the access cover for filter service now has quick release cover latches and a chain that connects the air cleaner service cover to the housing!



The large, massive mining vehicle in the picture above is an ideal match for the Donaldson SSG Air Cleaner.

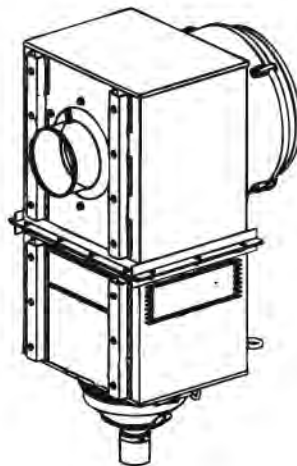

Mounting (back) side view of an SSG 20 model

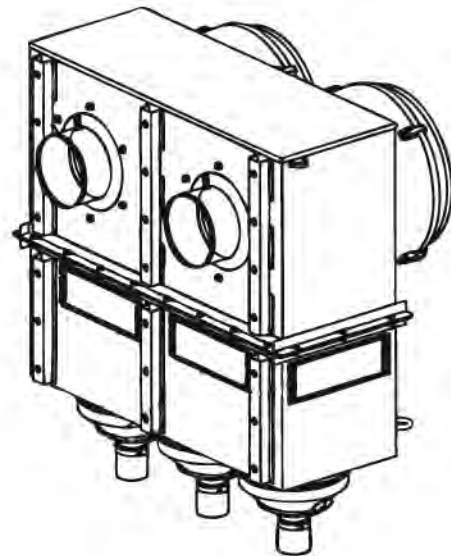

Mounting (back) side view of an SSG 29 model

Covered by issued and pending patents, both U.S. and internationally

HEAVY DUST

Versatile SSG Provides Airflow to 4800 cfm With Improved Design Features Compared to our Older SRG Model

Applications

- Allows 1700 to 2400 cfm airflow throughput for the SSG 20 model and 2580 to 4800 cfm airflow throughput for the SSG 29 models
- Horizontal installation
- Off-road, heavy or extreme dust conditions
- Ideal for scrapers, earth movers, graders

Air Cleaner Features

- Single and dual outlet models - two high-flow models available
- Inlet has perforated holes on three sides; rain shrouds available if required
- Filters have urethane end caps with radial seal sealing technology
- Built-in pre-cleaning tubes separate up to 97% of the in-coming dust
- Latch-style cover with attached safety chain for faster and simpler filter service
- Constructed of heavy-gauge steel with a primed, ready-to-paint finish
- Same overall package size as older Donaldson SRG axial seal style housings
- Dust Dumpa tube accessory available simplifies routine air cleaner inspections

Filter Features

- Replacement primary filter choices: Standard life filters (for scheduled maintenance) and Donaldson Endurance™ extended service high efficiency filters. Air cleaners ship with the standard filters.
- Grab handles on the primary filter to help remove the loaded filter during service
- Safety filter on all models



The large, massive mining vehicle in the picture above is an ideal match for the Donaldson SSG Air Cleaner.

Powerful Two-Stage Filtration

The first stage of this powerful air cleaner consists of hundreds of our exclusive, patented Donaclone™ pre-cleaner tubes (over 130 tubes in the SSG 20 and over 250 tubes in the SSG 29 models). Each tube spins the incoming air to create a centrifugal force that separates up to 97% of the dust and dirt in the airstream (see image on right). Donaclone™ tubes have no moving parts – so there is nothing to break down or maintain. They function properly whenever the engine is running.

The pre-cleaned dust is automatically ejected from the dust cup with a Vacuator™ Valve located below in the lower housing body, below the Donaclone tubes.

The second stage of filtration is the primary filter. A safety filter, which fits inside the primary filter, is standard on all models for protection during primary filter changeout.



Side view of three Donaclone pre-cleaning tubes.

When spec'ing an Air Cleaner . . .

Determine the airflow requirements of your engine, then find the corresponding cfm airflow in the table at right. The restriction numbers (shown in inches of water) indicate the approximate initial restriction of each model air cleaner at that cfm. If there are two air cleaner models that fit your parameters, choosing the one with the lowest restriction will provide longest filter service life. When calculating total initial restriction of the entire air intake system, include the restriction caused by ducting, elbows, pre-cleaners, etc.

Initial Airflow Restriction

CFM @ "H2O		Air Cleaner Model
6"	8"	
SINGLE OUTLET MODELS		
1700	1980	G200087
1780	2060	G200086
2100	2400	G200088*
DUAL OUTLET MODELS		
2580	3000	G290057
3340	3800	G290052
3600	4080	G290053
4200	4800	G290055*

* Sized to accommodate higher airflow.

Airflow Pattern "G"

Air in the side, through the pre-cleaner, out the end of the air cleaner (upper) portion.

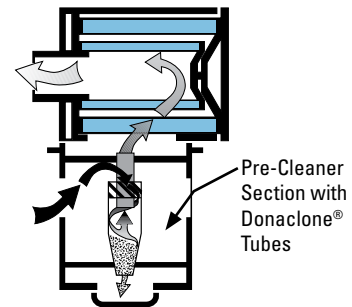

SSG Specification Illustrations

Front View Dual Outlet

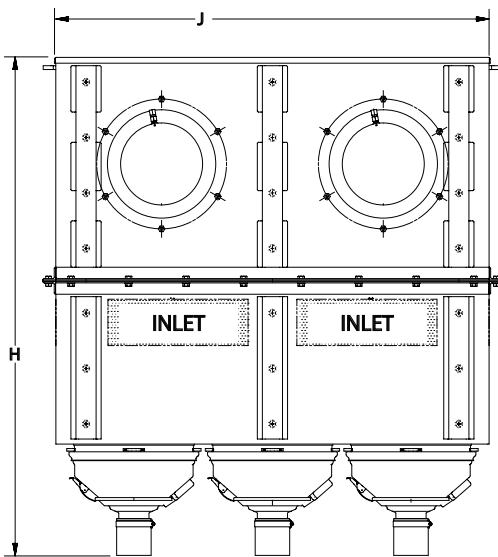

Front View Single Outlet

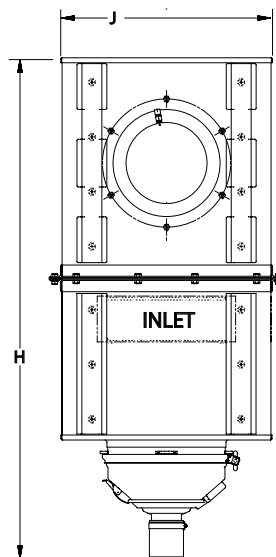

Side View Dual and Single

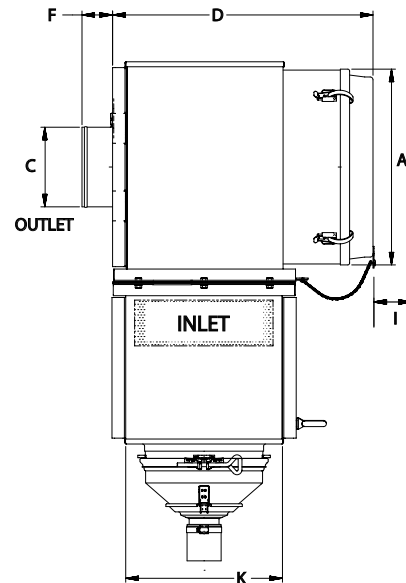

SSG Specifications

Air Cleaner Models	Body Diameter (A)		Outlet Diameter (C)		Length (D)		Outlet Length (F)		Height (H)		Service Clearance (I)		Width (J)		Depth (K)		Weight lbs kg	
	in	mm	in	mm	in	mm	in	mm	in	mm	in	mm	in	mm	in	mm	lbs	kg
SINGLE OUTLET MODELS																		
G200087	19.67	500	8.0	203	26.2	665	3	76	50.15	1274	22.0	559	21.00	533	15.75	400	200	91
G200086	19.67	500	10.0	254	26.2	665	3	76	50.15	1274	22.0	559	21.00	533	15.75	400	200	91
G200088	19.67	500	10.0	254	31.4	798	3	76	50.15	1274	27.0	686	21.00	533	23.50	597	240	109
DUAL OUTLET MODELS																		
G290057	19.67	500	8.0	203	26.2	665	3	76	49.42	1255	22.0	559	43.00	1092	15.75	400	340	154
G290052	19.67	500	8.0	203	26.2	665	3	76	49.42	1255	22.0	559	43.00	1092	15.75	400	340	154
G290053	19.67	500	10.0	254	26.2	665	3	76	49.42	1255	22.0	559	43.00	1092	15.75	400	340	154
G290055	19.67	500	10.0	254	31.4	798	3	76	49.42	1255	27.0	686	43.00	1092	23.50	597	420	190

HEAVY DUST

Service Parts Listing by Model Number

Single Outlet Model - SSG 20

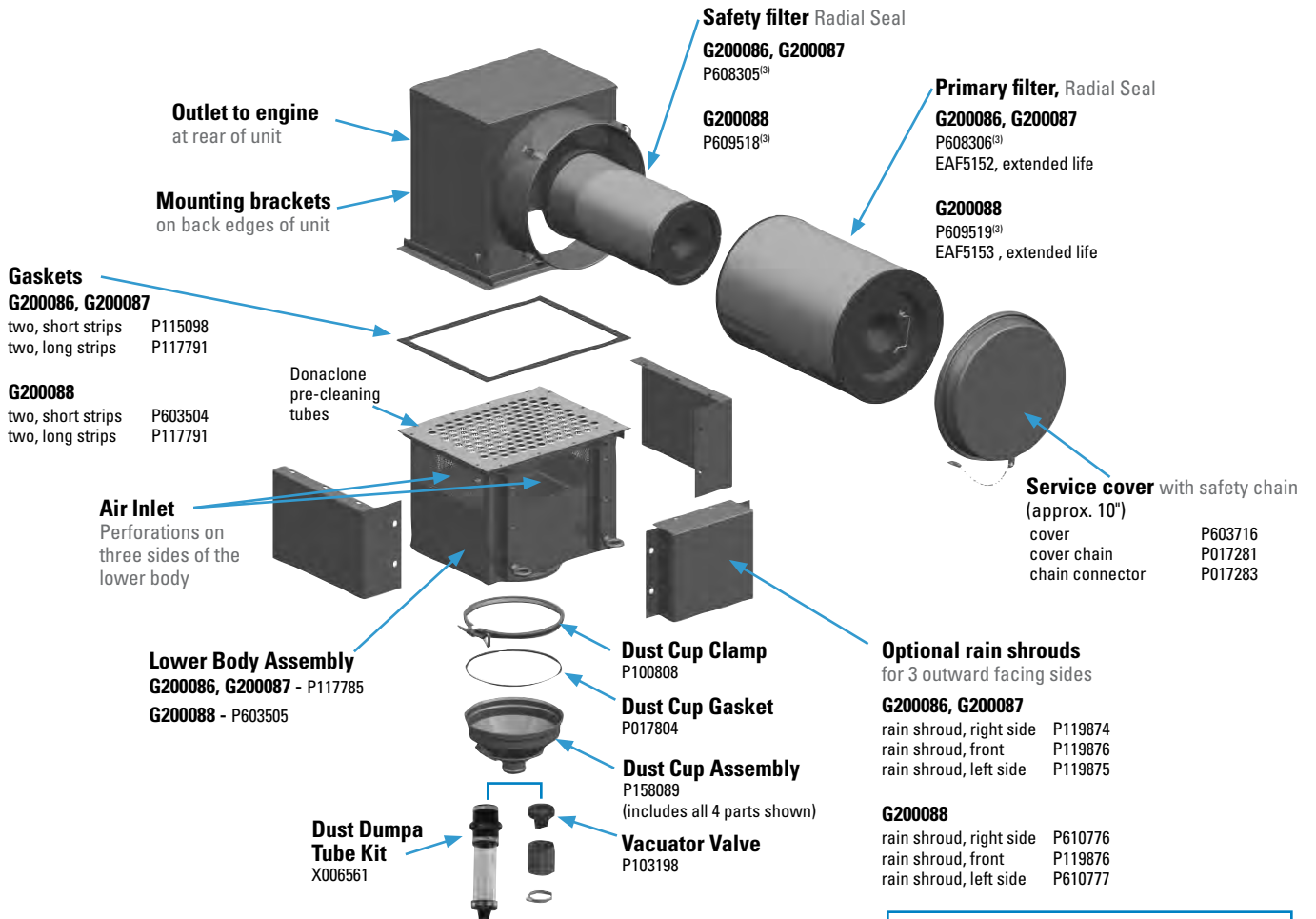

NOTES:
3 = Shipped with air cleaner initially

Dust Dumpa Tube Extension

How it works: When installed on the dust cups on the lower assembly, the rubber connector vibrates during normal vehicle operation and gravity expels the pre-cleaned dust.

- Improves dust evacuation from the air cleaner
- Clear tube allows for visual inspection of dust collection
- Reduces air cleaner inspection time
- Ships fully assembled
- Proper conversion requires drop down tube for every dust cup



Part No. X006561

NEW

For more information features and dimensions, see accessories section.

Service Parts Listing by Model Number

Dual Outlet Model - SSG 29

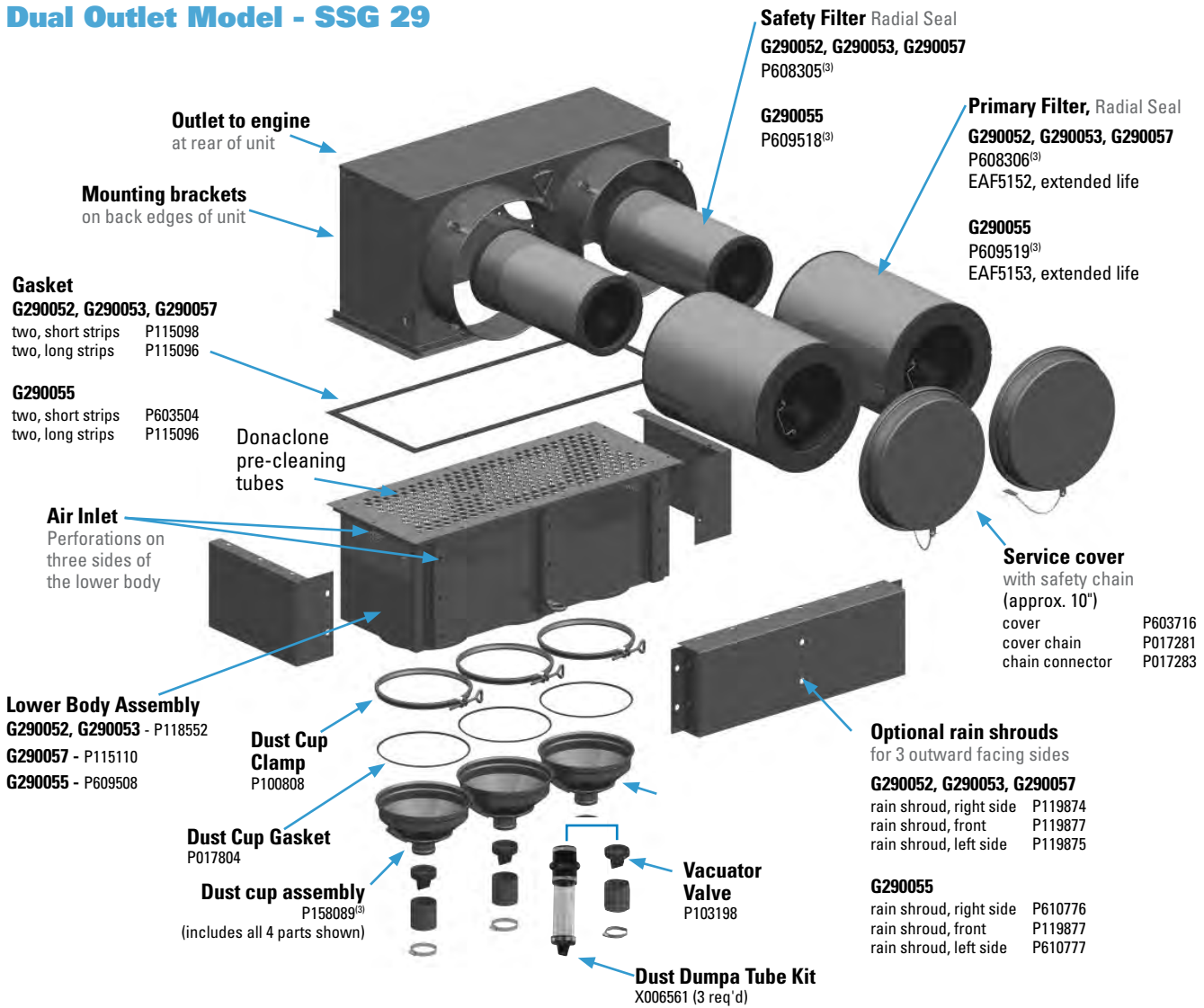

NOTES:
3 = Shipped with air cleaner initially

Dust Dumpa Tube Extension

How it works: When installed on the dust cups on the lower assembly, the rubber connector vibrates during normal vehicle operation and gravity expels the pre-cleaned dust.

- Improves dust evacuation from the air cleaner
- Clear tube allows for visual inspection of dust collection
- Reduces air cleaner inspection time
- Ships fully assembled
- Proper conversion requires drop down tube for every dust cup

For more information features and dimensions, see accessories section.



NEW

Part No. X006561