

# P-BE Stainless Steel Tank Vent Filter Housing

*Filter housing for the aeration and de-aeration of sterile storage tanks or containers for transport.*

The Donaldson® P-BE filter housings are used for sterile ventilation of stationary and mobile storage tanks used in the food, beverage, pharmaceutical, chemical and other industries. The two-piece housing is designed to prevent liquids from coming into contact with the element itself.

The P-BE tank vent filter is available in 12 sizes with flow rates ranging from 1 to 1,200 cfm (at ambient pressure).

## Choose the Filter to Suit Your Application

The P-BE vent housing is usually used in conjunction with our UltradePTH II™ P-BE vent filter element to assure sterile ventilation with very little pressure drop or air resistance. However, it can be used with many other filter types to meet your specific need.



**P-BE** stainless steel housing for venting storage and holding tanks. Accommodates a variety of filter element types.

## Specifications

### Materials

Filter Housings: 304 SS or 316L SS  
Attached Parts: 304 SS

### Maximum Operating Temperature

390°F

### Connection Types

Models 0006-0192: Tri-Clamp  
Models 0432-1920: ANSI Flange

### Surface Finish

All Models: Electropolished to Ra 30

## Dimensions

### Vent Filter with Tri-Clamp Connection

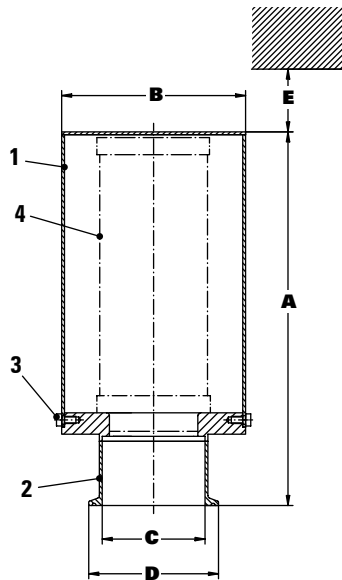

Position	Piece	Description
1	1	upper housing bowl
2	1	lower housing bowl
3	3	socket head screw
4	1	filter element

Size	Weight* (lb)	Dimensions (inches)					Element Size
		A	B	C	D	E	
0006	3.3	4.7	3.3 x 0.08	1.5	2	4	03/10
0027	4.8	7.1	4.1 x 0.08	1.5	2	6.1	05/25
0032	5.3	7.1	4.5 x 0.08	2	2.5	6.1	05/30
0072	7.3	12.2	5.1 x 0.08	2	2.5	11	10/30
0144	20.3	22.8	5.1 x 0.08	3	3.6	22.8	20/30
0192	25.6	32.7	5.1 x 0.08	3	3.6	33.5	30/30

### Vent Filter with ANSI Flange Connection

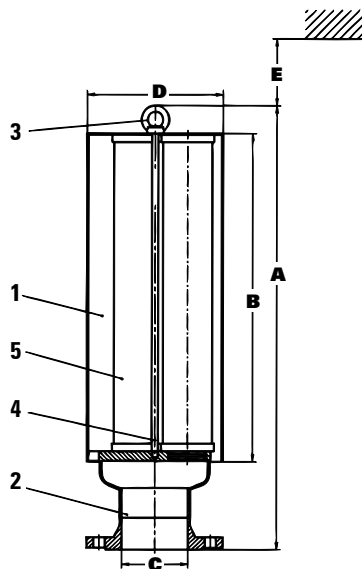

Position	Description
1	upper housing bowl
2	lower housing bowl
3	lifting eye screw
4	anchor bolt
5	filter element

Size	Weight* (lb)	Dimensions (inches)					Element Size
		A	B	C**	D	E	
0432	32.5	26.4	20.9	4	8.7	21.6	3 x 20/30
0576	39	36.4	30.7	4	8.7	31.5	3 x 30/30
0768	46.5	36.8	30.7	4	10.8	31.5	4 x 30/30
1152	66.5	37.4	30.7	6	12.8	31.5	6 x 30/30
1536	89	37.4	30.7	6	15.5	31.5	8 x 30/30
1920	95.5	37.8	30.7	8	15.5	31.5	10 x 30/30

\* Without filter element

\*\* 150 lbs ANSI B16.5



Donaldson Company, Inc.  
 Process Filtration  
 P.O. Box 1299  
 Minneapolis, MN  
 55440-1299 U.S.A.

Tel 800.543.3634 (USA)  
 Tel 800.343.3639 (within Mexico)  
 processfilters@donaldson.com  
 donaldson.com

Information in this document  
 is subject to change without notice.

© 2007 Donaldson Co., Inc.  
 Printed in U.S.A. on recycled paper

Bulletin No. PRO-213 P-BE Filter Housing 12-08