

TABLE OF CONTENTS

- EASY DUCT ANGLE FLANGE4-5**
- EASY DUCT BRANCH6**
- EASY DUCT CLAMP.....7**
- EASY DUCT ELBOW8-9**
- EASY DUCT LONG RADIUS ELBOW 10**
- EASY DUCT MACHINE ADAPTER 11**
- EASY DUCT MANUAL BLAST GATE..... 12**
- EASY DUCT PIPE 13**
- EASY DUCT REDUCER..... 14**
- EASY DUCT RIGID STEEL HOSE 15**
- EASY DUCT RUBBER HOSE 16**
- EASY DUCT SLEEVE 17**
- EASY DUCT ULTRA STEEL HOSE..... 18**
- EASY DUCT Y BRANCH..... 19**

Ordering Information

- When ordering, specify material and dimension.
- Flat Flanges also available with custom drill patterns. ANSI Flange patterns are charged double the standard. Call for pricing on other options.

| Ø in. | ID in. | OD in. | H in. | T in. | Qty holes | Hole Ø in. | Bolt Circle in. | Weight Lbs |
|-------|--------|--------|-------|-------|-----------|------------|-----------------|------------|
| 3 | 3.06 | 5.06 | 1 | .125 | 6 | 9/32 | 4.31 | .70 |
| 4 | 4.06 | 6.06 | 1 | .125 | 6 | 9/32 | 5.31 | .85 |
| 5 | 5.06 | 7.06 | 1 | .125 | 6 | 9/32 | 6.31 | 1.18 |
| 6 | 6.09 | 8.59 | 1.25 | .125 | 6 | 9/32 | 7.31 | 1.38 |
| 7 | 7.13 | 9.63 | 1.25 | .125 | 6 | 3/8 | 8.50 | 1.73 |
| 8 | 8.13 | 10.63 | 1.25 | .125 | 6 | 3/8 | 9.56 | 1.90 |
| 9 | 9.13 | 11.63 | 1.25 | .125 | 6 | 7/16 | 10.63 | 2.55 |
| 10 | 10.13 | 12.63 | 1.25 | .125 | 6 | 7/16 | 11.81 | 3.05 |
| 11 | 11.13 | 13.63 | 1.25 | .125 | 6 | 7/16 | 12.75 | 3.25 |
| 12 | 12.13 | 15.13 | 1.5 | .125 | 8 | 7/16 | 14.00 | 3.88 |
| 13 | 13.13 | 16.13 | 1.5 | .125 | 8 | 7/16 | 15.00 | 4.25 |
| 14 | 14.13 | 17.13 | 1.5 | .125 | 8 | 7/16 | 16.00 | 4.75 |
| 15 | 15.13 | 18.13 | 1.5 | .125 | 8 | 7/16 | 17.00 | 7.25 |
| 16 | 16.13 | 19.13 | 1.5 | .1875 | 8 | 7/16 | 18.00 | 8.00 |
| 17 | 17.13 | 20.13 | 1.5 | .1875 | 8 | 7/16 | 19.00 | 8.25 |
| 18 | 18.13 | 21.13 | 1.5 | .1875 | 8 | 7/16 | 20.00 | 8.50 |
| 19 | 19.13 | 22.13 | 1.5 | .1875 | 12 | 7/16 | 20.75 | 8.75 |
| 20 | 20.13 | 23.13 | 1.5 | .1875 | 12 | 7/16 | 21.75 | 9.50 |
| 21 | 21.13 | 24.13 | 1.5 | .1875 | 12 | 7/16 | 22.75 | 10.25 |
| 22 | 22.13 | 25.13 | 1.5 | .1875 | 12 | 7/16 | 23.75 | 10.75 |
| 23 | 23.13 | 26.13 | 1.5 | .1875 | 12 | 7/16 | 24.88 | 11.25 |
| 24 | 24.13 | 27.13 | 1.5 | .1875 | 12 | 7/16 | 25.88 | 11.50 |
| 25 | 25.13 | 28.13 | 1.5 | .1875 | 16 | 7/16 | 26.88 | 12.00 |
| 26 | 26.13 | 30.13 | 2 | .1875 | 16 | 7/16 | 28.38 | 16.75 |
| 27 | 27.13 | 31.13 | 2 | .1875 | 16 | 7/16 | 29.38 | 17.38 |
| 28 | 28.13 | 32.13 | 2 | .1875 | 16 | 7/16 | 30.38 | 18.00 |
| 29 | 29.13 | 33.13 | 2 | .1875 | 16 | 7/16 | 31.38 | 18.75 |
| 30 | 30.13 | 34.13 | 2 | .1875 | 16 | 7/16 | 32.38 | 19.50 |
| 31 | 31.13 | 35.13 | 2 | .1875 | 16 | 7/16 | 33.38 | 20.38 |
| 32 | 32.13 | 36.13 | 2 | .1875 | 16 | 7/16 | 34.38 | 20.75 |
| 33 | 33.13 | 37.13 | 2 | .1875 | 16 | 7/16 | 35.38 | 21.25 |
| 34 | 34.13 | 38.13 | 2 | .1875 | 16 | 7/16 | 36.38 | 22.00 |
| 35 | 35.13 | 39.13 | 2 | .1875 | 16 | 7/16 | 37.38 | 22.50 |
| 36 | 36.13 | 40.13 | 2 | .1875 | 16 | 7/16 | 38.38 | 23.00 |
| 37 | 37.13 | 41.13 | 2 | .1875 | 24 | 7/16 | 39.38 | 23.75 |
| 38 | 38.13 | 42.13 | 2 | .1875 | 24 | 7/16 | 40.38 | 24.50 |
| 39 | 39.13 | 43.13 | 2 | .1875 | 24 | 7/16 | 41.38 | 25.00 |
| 40 | 40.13 | 44.13 | 2 | .1875 | 24 | 7/16 | 42.38 | 25.75 |
| 42 | 42.13 | 46.13 | 2 | .1875 | 24 | 7/16 | 44.38 | 26.50 |
| 44 | 44.13 | 48.13 | 2 | .1875 | 24 | 7/16 | 46.38 | 28.00 |
| 46 | 46.13 | 50.13 | 2 | .1875 | 24 | 7/16 | 48.38 | 29.00 |
| 48 | 48.13 | 52.13 | 2 | .1875 | 24 | 7/16 | 50.38 | 30.75 |
| 50 | 50.13 | 54.13 | 2 | .1875 | 24 | 7/16 | 52.38 | 32.00 |
| 52 | 52.13 | 56.13 | 2 | .1875 | 24 | 7/16 | 54.38 | 33.40 |
| 54 | 54.13 | 58.13 | 2 | .1875 | 24 | 7/16 | 56.38 | 34.80 |

(see page 2 for larger sizes)

Material Options

| Galv | | SS | |
|-----------|--------|-----------|--------|
| Size (in) | | Size (in) | |
| Min. Ø | Max. Ø | Min. Ø | Max. Ø |
| 3 | 72 | 3 | 40 |

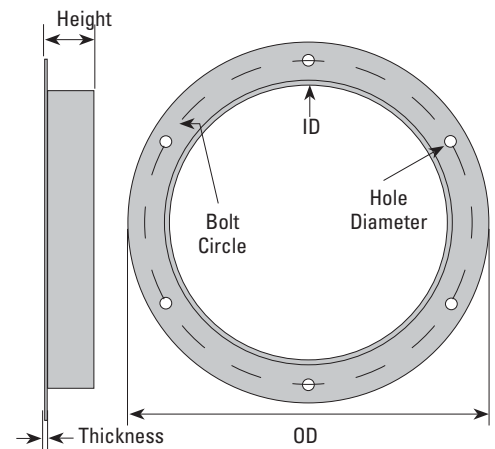
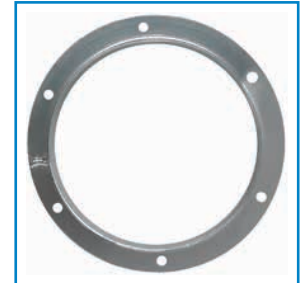

Notes:

- Angle Flanges are only available with the hole patterns shown.
- For different hole patterns or no holes, laser technology can be used to burn Flat Flanges to match your requirements.

Hardware:

Hardware is not supplied with flanges and must be supplied by customer:

- 7/16" holes – use 3/8-16 x 1-1/2" lockwasher, and hex nut - Grade 5 or better
- 3/8" holes – use 5/16-18 x 1-1/2" lockwasher, and hex nut - Grade 5 or better
- 9/32" holes – use 1/4-20 x 1-1/2" lockwasher, and hex nut - Grade 5 or better

| Ø in. | ID in. | OD in. | H in. | T in. | Qty holes | Hole Ø in. | Bolt Circle in. | Weight Lbs |
|-------|--------|--------|-------|-------|-----------|------------|-----------------|------------|
| 56 | 56.13 | 60.13 | 2 | .1875 | 24 | 7/16 | 58.38 | 36.00 |
| 58 | 58.14 | 62.14 | 2 | .1875 | 32 | 7/16 | 60.38 | 37.00 |
| 60 | 60.13 | 64.13 | 2 | .1875 | 32 | 7/16 | 62.38 | 38.50 |
| 62 | 62.13 | 66.13 | 2 | .1875 | 32 | 7/16 | 64.38 | 39.80 |
| 64 | 64.13 | 68.13 | 2 | .1875 | 32 | 7/16 | 66.38 | 41.00 |
| 66 | 66.13 | 70.13 | 2 | .1875 | 36 | 7/16 | 68.38 | 42.40 |
| 68 | 68.13 | 72.13 | 2 | .1875 | 36 | 7/16 | 70.38 | 43.50 |
| 70 | 70.13 | 74.13 | 2 | .1875 | 36 | 7/16 | 72.38 | 44.90 |
| 72 | 72.13 | 76.13 | 2 | .1875 | 36 | 7/16 | 74.38 | 46.30 |

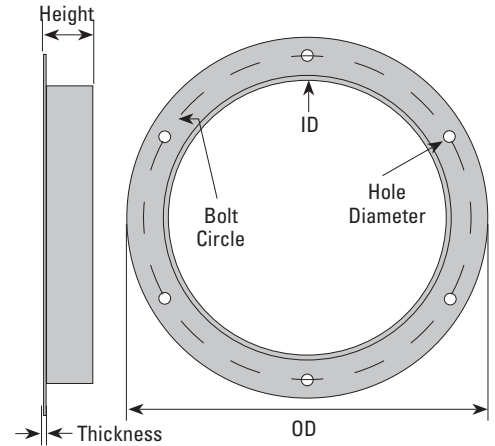

Important Notice: Many factors beyond the control of Donaldson can affect the use and performance of Donaldson products in a particular application, including the conditions under which the product is used. Since these factors are uniquely within the user's knowledge and control, it is essential the user evaluate the products to determine whether the product is fit for the particular purpose and suitable for the user's application. All products, product specifications, availability and data are subject to change without notice, and may vary by region or country.



Donaldson Company, Inc.
 Minneapolis, MN
donaldson.com • shop.donaldson.com

North America
 Email: donaldson@donaldson.com
 Phone: (USA): +1-800-365-1331
 (MX): +1-800-343-36-39

Australasia
 Email: marketing.australia@donaldson.com
 Phone: +61-2-4350-2000
 Toll Free: (AU) +1800-345-837 • (NZ) +0800-743-387

China
 Email: info.cn@donaldson.com
 Phone: +86-400-820-1038

Donaldson Europe B.V.B.A.
 Email: IAF-europe@donaldson.com
 Phone: +32-16-38-3811

India
 Email: info.difs@donaldson.com
 Phone: +91-124-4807-400 • +18001035018

Japan
 Email: jp-ndi.ifsw@donaldson.com
 Phone: +81-42-540-4112

Korea
 Email: iaf-kr@donaldson.com
 Phone: +82-2-517-3333

Latinoamerica
 Email: IndustrialAir@donaldson.com
 Phone: +52-449-300-2442

South Africa
 Email: SAMarketing@donaldson.com
 Phone: +27-11-997-6000

Southeast Asia
 Email: IAF.SEA@donaldson.com
 Phone: +65-6311-7373

F118198 ENG (02/20) Easy Duct Angle Flange
 ©2019-2020 Donaldson Company, Inc. Donaldson, Torit, Easy Duct, and the color blue are marks of Donaldson Company, Inc. All other marks belong to their respective owners.

Ordering Information

- When ordering, specify, specify material, gauge (if non-standard), dimensions A, B, C, end styles, and angle (standard 30°, optional 45°).
- A - C ≥ C - B
- Use previous formula to determine if a reducer is needed at C.
- 14 Gauge Branches:**
 - Any Branch with B, or C end smaller than 8" will be hybrid. (Smaller section will be a lighter gauge.)



| AØ (in.) | Length (in.) | Weight (lbs) | |
|----------|---|---|--------|
| 3 | QF or Raw ends: Length = C X 2 + 9" | 2.32 | |
| 4 | | 3.00 | |
| 5 | | 3.75 | |
| 6 | | 4.25 | |
| 7 | | 5.00 | |
| 8 | | 6.00 | |
| 9 | | 7.25 | |
| 10 | | 8.50 | |
| 11 | | 9.25 | |
| 12 | | 10.75 | |
| 13 | | 11.40 | |
| 14 | | To manufacture, A - C must be greater to or equal to C - B | 13.50 |
| 15 | | | 15.60 |
| 16 | 17.56 | | |
| 17 | 19.00 | | |
| 18 | 21.00 | | |
| 19 | 25.00 | | |
| 20 | 30.00 | | |
| 21 | 35.00 | | |
| 22 | 39.50 | | |
| 23 | 47.00 | | |
| 24 | 53.50 | | |
| 25 | Angle Flange or Flat Flange ends: Length = C X 2 + 15" | | 63.00 |
| 26 | | 74.00 | |
| 27 | | 81.00 | |
| 28 | | 98.00 | |
| 29 | | 107.00 | |
| 30 | | 117.05 | |
| 31 | | 121.00 | |
| 32 | | 125.94 | |
| 33 | | 130.00 | |
| 34 | | To manufacture, A - C must be greater to or equal to C - B | 134.83 |
| 35 | | | 138.00 |
| 36 | | | 142.78 |
| 37 | | | 148.00 |
| 38 | | | 153.47 |
| 39 | | | 158.00 |
| 40 | 162.81 | | |

QF Material Options

| Galv | | | | SS | | | |
|----------|---------------|--------|--------|---------------|--------|----|----|
| Gauges | Size (inches) | | Gauges | Size (inches) | | | |
| | Min. Ø | Max. Ø | | Min. Ø | Max. Ø | | |
| Standard | 22 | 3 | 12 | Standard | 22 | 3 | 12 |
| | 20 | 13 | 24 | | 20 | 13 | 24 |
| Optional | 16 | 8 | 24 | Optional | 16 | 8 | 24 |
| | 14 | 8 | 24 | | | | |

Flanged Material Options

| Galv | | | | SS | | | | |
|----------|---------------|--------|--------|---------------|--------|----|----|--|
| Gauges | Size (inches) | | Gauges | Size (inches) | | | | |
| | Min. Ø | Max. Ø | | Min. Ø | Max. Ø | | | |
| Standard | 22 | 3 | 15 | Standard | 22 | 3 | 15 | |
| | 20 | 16 | 40 | | 20 | 16 | 40 | |
| Optional | 18 | 26 | 40 | Optional | 18 | 26 | 40 | |
| | 16 | 8 | 40 | | 16 | 8 | 40 | |
| | 14 | 8 | 50 | | | | | |
| | 12 | 10 | 72 | | | | | |
| | 10 | 12 | 72 | | | | | |

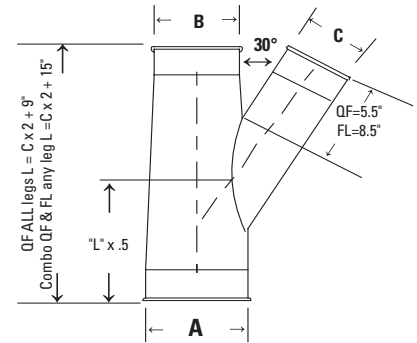

Please carefully note
Branch End Label
designations (ABC)

Collars:

Located on the exterior side of each port and considered as air flow non-directional. Collars have a laser welded longitudinal seam. If air flow directional product is required, it must be stated on the PO and additional cost may be incurred. A raised lap seam and spot weld are used for attaching the collar to the body and no caulking is used. If caulking is required, additional cost may be incurred.

14ga and 12ga - Collars have a plasma welded longitudinal seam

Optional End Styles

Standard QF end can be changed to Raw ID (RAWID), Raw OD (RAWOD), No Fitting (NF), Hose Adapter (RAWFLEX), Flat Flange (FFL), Angle Flange (AFL), or Van Stone (VANSTONE).

Construction

Seam: Longitudinal seam is lapped, spot welded, and caulked on standard gauges.

14ga and 12ga - Solid butt welds.

Important Notice: Many factors beyond the control of Donaldson can affect the use and performance of Donaldson products in a particular application, including the conditions under which the product is used. Since these factors are uniquely within the user's knowledge and control, it is essential the user evaluate the products to determine whether the product is fit for the particular purpose and suitable for the user's application. All products, product specifications, availability and data are subject to change without notice, and may vary by region or country.

Donaldson Company, Inc.
Minneapolis, MN
donaldsontorit.com • shop.donaldson.com

North America
Email: donaldsontorit@donaldson.com
Phone: (USA): +1-800-365-1331 • (MX): +1-800-343-36-39

Australasia
Email: marketing.australia@donaldson.com
Phone: +61-2-4350-2000
Toll Free: (AU) +1800-345-837 • (NZ) +0800-743-387

China
Email: info.cn@donaldson.com
Phone: +86-400-820-1038

Donaldson Europe B.V.B.A.
Email: IAF-europe@donaldson.com
Phone: +32-16-38-3811

India
Email: info.difs@donaldson.com
Phone: +91-124-4807-400 • +18001035018

Japan
Email: jp-ndl.ifsweb@donaldson.com
Phone: +81-42-540-4112

Korea
Email: iaf-kr@donaldson.com
Phone: +82-2-517-3333

Latinoamerica
Email: IndustrialAir@donaldson.com
Phone: +52-449-300-2442

South Africa
Email: SAMarketing@donaldson.com
Phone: +27-11-997-6000

Southeast Asia
Email: IAF.SEA@donaldson.com
Phone: +65-6311-7373

Ordering Information

- Galvanized and Stainless Steel QF Clamps are standard from factory with Nitrile seal and bridge pin.
- Silicone or ePTFE seals are optional - specify when ordering. Clamps also may be ordered optionally without seals.
- Galvanized clamp supplied with galvanized bridge pin. SS clamp supplied with SS bridge pin.
- 3" to 6" QF Clamps: Small bridge pin with 3/8" wide seal from factory.
- 7" to 11" QF Clamps: Large bridge pin with 1/2" wide seal from factory.
- 12" to 24" QF Clamps: Large bridge pin with 5/8" wide seal from factory.
- Replacement seals: Nitrile and Silicone seals stocked in rolls of 50'. ePTFE seals stocked in rolls of 100'.



| Ø in. | Weight Lbs |
|-------|------------|
| 3 | 4.00 |
| 4 | 5.35 |
| 5 | 6.65 |
| 6 | 7.93 |
| 7 | 11.70 |
| 8 | 13.25 |
| 9 | 14.92 |
| 10 | 16.60 |
| 11 | 18.10 |
| 12 | 19.75 |
| 13 | 21.40 |
| 14 | 27.30 |
| 15 | 29.25 |
| 16 | 31.15 |
| 17 | 33.09 |
| 18 | 34.00 |
| 19 | 36.00 |
| 20 | 38.00 |
| 21 | 40.00 |
| 22 | 42.00 |
| 23 | 44.00 |
| 24 | 45.82 |

| | QF Clamps Galv or SS with Nitrile Seals | | Optional | QF Clamps Galv or SS with Silicone Seals | | Optional | QF Clamps Galv or SS with ePTFE Seals | |
|----------|---|--------|----------|--|--------|----------|---------------------------------------|--------|
| | Size (in) | | | Size (in) | | | Size (in) | |
| | Min. Ø | Max. Ø | | Min. Ø | Max. Ø | | Min. Ø | Max. Ø |
| Standard | 3 | 24 | | 3 | 24 | | 3 | 24 |



Additional Small or Large Bridge Pins may be purchased.

What is the best seal for my application?

Nitrile seals are inserted into QF Clamps as standard. Rated for max. intermittent service temperatures of 194° and continuous 158° F, there is no additional charge for nitrile so it is the most economical choice.

Silicone seals are an economically priced option for operating temperatures above 158° F. Rated for max. service temperature of 400° F, silicone has an extremely broad temperature range capability as it is also very good in low temperatures, remaining flexible at -60° F. Additionally, silicone offers superb resistance to weather aging and ozone.

ePTFE seals are not degraded by any common chemicals (0 - 14 pH range) FOR INDUSTRIAL USE ONLY. Not for use in food, drug, cosmetic or medical device manufacturing, processing, or packaging operations. Max. temperature rating of 600° F.



Clamps are "overlap" design.

Important Notice: Many factors beyond the control of Donaldson can affect the use and performance of Donaldson products in a particular application, including the conditions under which the product is used. Since these factors are uniquely within the user's knowledge and control, it is essential the user evaluate the products to determine whether the product is fit for the particular purpose and suitable for the user's application. All products, product specifications, availability and data are subject to change without notice, and may vary by region or country.

Donaldson Company, Inc.
Minneapolis, MN
donaldsontorit.com • shop.donaldson.com

North America
Email: donaldsontorit@donaldson.com
Phone: (USA): +1-800-365-1331 • (MX): +1-800-343-36-39

Australasia
Email: marketing.australia@donaldson.com
Phone: +61-2-4350-2000
Toll Free: (AU) +1800-345-837 • (NZ) +0800-743-387

China
Email: info.cn@donaldson.com
Phone: +86-400-820-1038

Donaldson Europe B.V.B.A.
Email: IAF-europe@donaldson.com
Phone: +32-16-38-3811

India
Email: info.difs@donaldson.com
Phone: +91-124-4807-400 • +18001035018

Japan
Email: jp-ndl.ifsw@donaldson.com
Phone: +81-42-540-4112

Korea
Email: iaf-kr@donaldson.com
Phone: +82-2-517-3333

Latinoamerica
Email: IndustrialAir@donaldson.com
Phone: +52-449-300-2442

South Africa
Email: SAMarketing@donaldson.com
Phone: +27-11-997-6000

Southeast Asia
Email: IAF.SEA@donaldson.com
Phone: +65-6311-7373

Ordering Information

- When ordering, specify material, gauge (if non-standard), dimension and end styles, degree (30°, 45°, 60°, or 90°).
- Elbows in heavier gauges can be supplied in solid welded construction at an additional cost.
- Other CLR's available upon request.

16 Gauge Elbows:

- 16ga Elbows are constructed of gores lapped over one another and spot welded.
- This is a directional elbow supplied with an arrow to indicate the direction of flow. Please specify direction if ordering ends other than QF.
- Interior buffing available with upcharge.
- Galvanized is 16 gauge with 16 gauge collars. SS is 16ga with 20ga collars.

14 Gauge Galvanized Elbows:

- Constructed of butt-welded gores.
- Interior buffing available with upcharge.
- If flanged, vanstone ends with rotational Angle Flanges standard. Welded flanges will be clocked at the centerline as standard.



Elbows in sizes 8" and larger are segmented.



Elbows in galvanized sizes 3" - 7" are press-formed.

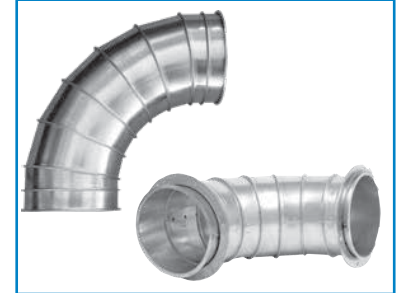

| | | |
|-------------------|--------------------------|-------|
| Degrees | 30° 45° 60° 90° | |
| Diameters CLR's | 3" - 7" | 1.0** |
| | 8" and larger | 1.5 |

Notes: * 1.0 Galv and 1.5 SS

| Ø in. | QF Std Weight Lbs | QF 16ga Weight Lbs | QF 14ga Weight Lbs | AFL Std Weight Lbs | AFL 14ga Weight Lbs |
|-------|-------------------|--------------------|--------------------|--------------------|---------------------|
| 3 | 0.90 | | | 1.75 | |
| 4 | 1.00 | | | 2.25 | |
| 5 | 1.20 | | | 2.80 | |
| 6 | 1.50 | | | 3.85 | |
| 7 | 2.20 | 9.42 | | 4.90 | |
| 8 | 6.10 | 13.64 | 19 | 7.66 | 23 |
| 9 | 7.60 | 16.64 | 24 | 8.45 | 29 |
| 10 | 9.00 | 21.54 | 29 | 15.47 | 35 |
| 11 | 10.50 | 27.65 | 35 | 17.60 | 41 |
| 12 | 12.40 | 33.76 | 42 | 19.33 | 49 |
| 13 | 14.26 | 40.07 | 46 | 22.40 | 54 |
| 14 | 19.00 | 46.38 | 50 | 25.39 | 59 |
| 15 | 21.25 | 52.61 | 54 | 27.90 | 69 |
| 16 | 24.00 | 58.83 | 59 | 30.51 | 75 |
| 17 | 27.50 | 66.14 | 63 | 32.30 | 80 |
| 18 | 30.90 | 73.44 | 68 | 34.67 | 85 |
| 20 | 35.97 | 85.40 | 97 | 41.99 | 110 |
| 22 | 43.06 | 107.98 | 103 | 46.90 | 124 |
| 24 | 55.50 | 132.63 | 131 | 70.96 | 154 |
| 26 | | | | 89.12 | 178 |
| 28 | | | | 99.19 | 214 |
| 30 | | | | 110.26 | 233 |
| 32 | | | | 121.38 | 274 |
| 34 | | | | 133.52 | 295 |
| 36 | | | | 149.04 | 340 |
| 38 | | | | 162.31 | 363 |
| 40 | | | | 176.20 | 414 |

QF Material Options

| Galv | | | |
|----------|---------------|--------|----|
| Gauges | Size (inches) | | |
| | Min. Ø | Max. Ø | |
| Standard | 24 | 3 | 7 |
| | 22 | 8 | 12 |
| | 20 | 13 | 24 |
| Optional | 16 | 7 | 24 |
| | 14 | 8 | 24 |

| SS | | | |
|----------|---------------|--------|----|
| Gauges | Size (inches) | | |
| | Min. Ø | Max. Ø | |
| Standard | 22 | 7 | 12 |
| | 20 | 13 | 24 |
| Optional | 18 | 8 | 24 |
| | 16 | 8 | 24 |

Flanged Material Options

| Galv | | | |
|----------|---------------|--------|----|
| Gauges | Size (inches) | | |
| | Min. Ø | Max. Ø | |
| Standard | 24 | 3 | 7 |
| | 22 | 8 | 12 |
| | 20 | 13 | 24 |
| | 18 | 26 | 32 |
| | 16 | 32 | 40 |
| Optional | 14 | 8 | 50 |
| | 12 | 10 | 72 |
| | 10 | 12 | 72 |

| SS | | | |
|----------|---------------|--------|----|
| Gauges | Size (inches) | | |
| | Min. Ø | Max. Ø | |
| Standard | 22 | 7 | 12 |
| | 20 | 13 | 24 |
| | 18 | 8 | 24 |
| | 16 | 8 | 24 |

Construction

3"-7":

Standard galvanized steel 3" to 7" elbows are press formed. Press formed halves are stitch welded together with rolled ends.

Stainless steel 3" to 6" elbows are tubed. Press formed halves are stitch welded together with rolled ends.

8" to 24":

8" and larger elbows shown here are gored (segmented) construction with a lock form standing seam every 15°. Gores are spot welded and caulked.

These elbows are produced as follows:

| Degree of angle | Number of gores |
|-----------------|-----------------------------------|
| 30° | (1) 15° + (2) 7.5° + (2) tangents |
| 45° | (2) 15° + (2) 7.5° + (2) tangents |
| 60° | (3) 15° + (2) 7.5° + (2) tangents |
| 90° | (5) 15° + (2) 7.5° + (2) tangents |

Optional End Styles

Standard QF end can be changed to Raw ID (RAWID), Raw OD (RAWOD), No Fitting (NF), Hose Adapter (RAWFLEX), Flat Flange (FFL), Angle Flange (AFL), or Van Stone (VANSTONE). Angle Flange (ANGFL) - Nordfab Angle Flange is industry standard angle flange with pre-drilled holes.

Collars: Collar is located on the exterior side of each port and considered as airflow non-directional. Collars have a laser welded longitudinal seam. If air flow directional product is required, it must be stated on the PO and additional cost may be incurred. A raised lap seam and spot weld are used for attaching the collar to the body and no caulking is used. If caulking is required, additional cost is incurred.

| Ø in. | Tangents QF | | Tangents AFL | |
|----------|-------------|------|--------------|------|
| | Galv | SS | Galv | SS |
| 3 | 2.00 | 2.00 | 2.00 | 2.00 |
| 4 | 1.32 | 2.00 | | |
| 5 | 1.32 | 2.00 | | |
| 6 | 1.32 | 2.00 | | |
| 7 | 1.32 | 2.25 | | |
| 8 to 15 | 2.00 | 2.00 | 4.00 | 4.00 |
| 16 to 24 | 2.00 | 2.00 | | |
| 26 to 40 | | | | |

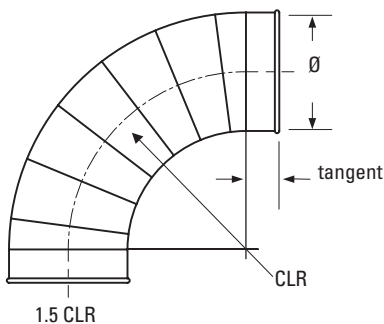

Notes: CLR= Center Line radius

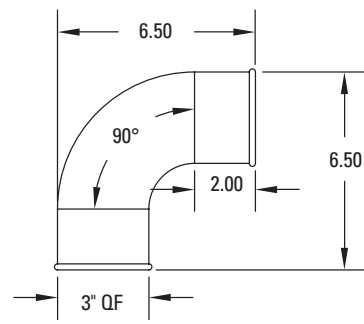
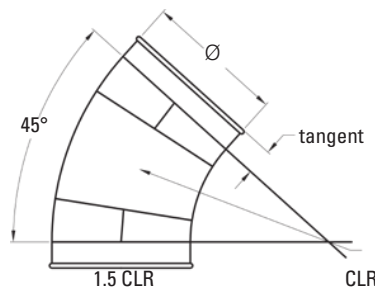

3" 90° Elbow (1.0CLR)

Important Notice: Many factors beyond the control of Donaldson can affect the use and performance of Donaldson products in a particular application, including the conditions under which the product is used. Since these factors are uniquely within the user's knowledge and control, it is essential the user evaluate the products to determine whether the product is fit for the particular purpose and suitable for the user's application. All products, product specifications, availability and data are subject to change without notice, and may vary by region or country.



Donaldson Company, Inc.
Minneapolis, MN
donaldson.com • shop.donaldson.com

North America
Email: donaldson@donaldson.com
Phone: (USA): +1-800-365-1331
(MX): +1-800-343-36-39

Australasia
Email: marketing.australia@donaldson.com
Phone: +61-2-4350-2000
Toll Free: (AU) +1800-345-837 • (NZ) +0800-743-387

China
Email: info.cn@donaldson.com
Phone: +86-400-820-1038

Donaldson Europe B.V.B.A.
Email: IAF-europe@donaldson.com
Phone: +32-16-38-3811

India
Email: info.difs@donaldson.com
Phone: +91-124-4807-400 • +18001035018

Japan
Email: jp-ndl.ifweb@donaldson.com
Phone: +81-42-540-4112

Korea
Email: iaf-kr@donaldson.com
Phone: +82-2-517-3333

Latinoamerica
Email: IndustrialAir@donaldson.com
Phone: +52-449-300-2442

South Africa
Email: SAMarketing@donaldson.com
Phone: +27-11-997-6000

Southeast Asia
Email: IAF.SEA@donaldson.com
Phone: +65-6311-7373

F118187 ENG (02/20) Easy Duct Elbow

©2019-2020 Donaldson Company, Inc. Donaldson, Torit, Easy Duct, and the color blue are marks of Donaldson Company, Inc. All other marks belong to their respective owners.

Ordering Information

- When ordering, specify material, gauge (if non-standard), dimension, end styles, degree (30°, 45°, 60°, or 90°) and note LR (Long Radius).
- Elbows in heavier gauges can be supplied in solid welded construction at an additional cost.
- Other CLR's available upon request.

16 Gauge Elbows:

- 16ga Elbows are constructed of gores lapped over one another and spot welded.
- This is a directional elbow supplied with an arrow to indicate the direction of flow. Please specify direction if ordering ends other than QF.
- Interior buffing available with upcharge.
- Galvanized is 16 gauge with 16 gauge collars. SS is 16ga with 20ga collars.

14 Gauge Galvanized Elbows:

- Constructed of butt-welded gores.
- Interior buffing available with upcharge.
- If flanged, vanstone ends with rotational Angle Flanges standard. Welded flanges will be clocked at the centerline as standard.
- One additional gore is included on each degree style.



Elbows in SS sizes 3" - 6" are Tubed.



| | | |
|-------------------|--------------------------|-------|
| Degrees | 30° 45° 60° 90° | |
| Diameters CLR's | 3" - 7" | 1.5** |
| | 8" - 24" | 2.5 |

Notes: * 1.5 Galv and 2.5 SS

Construction

3"-7":

Standard galvanized steel 3" to 7" elbows are press formed. Press formed halves are stitch welded together with rolled ends.

Stainless steel 3" to 6" elbows are tubed. Press formed halves are stitch welded together with rolled ends.

8" to 24":

8" and larger elbows shown here are gored (segmented) construction with a lock form standing seam every 15°. Gores are spot welded and caulked. See standard radius Elbow above for number of gores.

End Styles

Standard QF end can be changed to Raw ID (RAWID), Raw OD (RAWOD), No Fitting (NF), Hose Adapter (RAWFLEX), Flat Flange (FLL), Angle Flange (AFL), or Van Stone (VANSTONE). Angle Flange (ANGFL) - Nordfab Angle Flange is industry standard angle flange with pre-drilled holes.

Collars: Collar is located on the exterior side of each port and considered as airflow non-directional. Collars have a laser welded longitudinal seam. If air flow directional product is required, it must be stated on the PO and additional cost may be incurred. A raised lap seam and spot weld are used for attaching the collar to the body and no caulking is used. If caulking is required, additional cost is incurred.

QF Material Options

| | Galv | | | SS | | | |
|----------|--------|---------------|--------|----------|---------------|--------|----|
| | Gauges | Size (inches) | | Gauges | Size (inches) | | |
| | | Min. Ø | Max. Ø | | Min. Ø | Max. Ø | |
| Standard | 24 | 3 | 7 | Standard | 22 | 7 | 12 |
| | 22 | 8 | 12 | | 20 | 13 | 24 |
| | 20 | 13 | 24 | Optional | 18 | 8 | 24 |
| Optional | 16 | 7 | 24 | | 16 | 8 | 24 |
| | | 14 | 8 | 24 | | | |

Flanged Material Options

| | Galv | | | SS | | | |
|----------|--------|---------------|--------|----------|---------------|--------|----|
| | Gauges | Size (inches) | | Gauges | Size (inches) | | |
| | | Min. Ø | Max. Ø | | Min. Ø | Max. Ø | |
| Standard | 24 | 3 | 7 | Standard | 22 | 7 | 12 |
| | 22 | 8 | 12 | | 20 | 13 | 24 |
| | 20 | 13 | 24 | | 18 | 26 | 32 |
| | 18 | 26 | 32 | | 16 | 32 | 40 |
| | 16 | 32 | 40 | | | | |
| Optional | 14 | 8 | 50 | | | | |
| | 12 | 10 | 72 | | | | |
| | 10 | 12 | 72 | | | | |

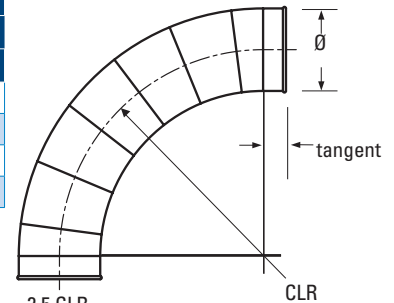

Notes: CLR= Center Line radius
** 7" Ø 16Ga elbow has a 2.5CLR

Important Notice: Many factors beyond the control of Donaldson can affect the use and performance of Donaldson products in a particular application, including the conditions under which the product is used. Since these factors are uniquely within the user's knowledge and control, it is essential the user evaluate the products to determine whether the product is fit for the particular purpose and suitable for the user's application. All products, product specifications, availability and data are subject to change without notice, and may vary by region or country.

Donaldson Company, Inc.
Minneapolis, MN
donaldsontorit.com • shop.donaldson.com

North America
Email: donaldsontorit@donaldson.com
Phone: (USA): +1-800-365-1331 • (MX): +1-800-343-36-39

Australasia
Email: marketing.australia@donaldson.com
Phone: +61-2-4350-2000
Toll Free: (AU) +1800-345-837 • (NZ) +0800-743-387

China
Email: info.cn@donaldson.com
Phone: +86-400-820-1038

Donaldson Europe B.V.B.A.
Email: IAF-europe@donaldson.com
Phone: +32-16-38-3811

India
Email: info.difs@donaldson.com
Phone: +91-124-4807-400 • +18001035018

Japan
Email: jp-ndl.ifswweb@donaldson.com
Phone: +81-42-540-4112

Korea
Email: iaf-kr@donaldson.com
Phone: +82-2-517-3333

Latinoamerica
Email: IndustrialAir@donaldson.com
Phone: +52-449-300-2442

South Africa
Email: SAMarketing@donaldson.com
Phone: +27-11-997-6000

Southeast Asia
Email: IAF.SEA@donaldson.com
Phone: +65-6311-7373

Ordering Information

- When ordering, specify material, gauge (if non-standard), dimension and end styles. Standard end styles are QF to NOFIT.
- If Expanded, specify desired ID or OD of non QF end.
- Must be within maximum opened dimension (.3"), or will be priced as reducer.

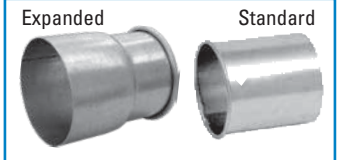

| Ø (in.) | Length (in.) | Raw End ID in. | Raw End OD in. | Max. Open Dim ID in. | Std Weight Lbs |
|---------|--------------|----------------|----------------|----------------------|----------------|
| 3 | 5.5 | 3.00 | 3.07 | 3.18 | 0.60 |
| 4 | 4 | 3.82 | 3.89 | 4.30 | 0.75 |
| 5 | | 4.84 | 4.91 | 5.30 | 0.95 |
| 6 | | 5.86 | 5.93 | 6.30 | 1.10 |
| 7 | | 6.87 | 6.94 | 7.30 | 1.35 |
| 8 | | 7.86 | 7.93 | 8.30 | 1.50 |
| 9 | | 8.85 | 8.92 | 9.30 | 1.75 |
| 10 | | 9.86 | 9.93 | 10.30 | 1.95 |
| 11 | | 10.85 | 10.92 | 11.30 | 2.10 |
| 12 | 11.92 | 11.99 | 12.30 | 2.30 | |
| 13 | 5.5 | 12.92 | 13.00 | 13.30 | 2.45 |
| 14 | | 13.91 | 13.99 | 14.30 | 2.70 |
| 15 | | 14.91 | 14.99 | 15.30 | 3.05 |
| 16 | | 15.92 | 16.00 | 16.30 | 3.20 |
| 17 | | 16.92 | 17.00 | 17.30 | 3.32 |
| 18 | | 17.91 | 17.99 | 18.30 | 3.45 |
| 19 | | 18.93 | 19.05 | 19.30 | 3.68 |
| 20 | | 19.92 | 20.00 | 20.30 | 3.90 |
| 21 | | 20.94 | 21.02 | 21.30 | 4.10 |
| 22 | | 21.93 | 22.01 | 22.30 | 4.30 |
| 23 | | 22.93 | 23.01 | 23.30 | 4.95 |
| 24 | | 23.90 | 23.98 | 24.30 | 5.60 |

QF Material Options

| Gauges | Galv | | | Gauges | SS | | |
|----------|---------------|--------|--------|----------|---------------|--------|--------|
| | Size (inches) | | Max. Ø | | Size (inches) | | Max. Ø |
| | Min. Ø | Max. Ø | | | Min. Ø | Max. Ø | |
| Standard | 22 | 3 | 12 | Standard | 22 | 3 | 12 |
| | 20 | 13 | 24 | | 20 | 13 | 24 |
| Optional | 18 | 4 | 24 | Optional | 18 | 8 | 24 |
| | 16 | 8 | 24 | | 16 | 8 | 24 |
| | 14 | 8 | 24 | | | | |

Flanged Material Options

| Gauges | Galv (Std) | | | Gauges | SS | | |
|----------|---------------|--------|--------|----------|---------------|--------|--------|
| | Size (inches) | | Max. Ø | | Size (inches) | | Max. Ø |
| | Min. Ø | Max. Ø | | | Min. Ø | Max. Ø | |
| Standard | 22 | 3 | 15 | Standard | 22 | 3 | 15 |
| | 20 | 16 | 40 | | 20 | 16 | 40 |
| Optional | 18 | 26 | 40 | Optional | 18 | 26 | 40 |
| | 16 | 8 | 40 | | 16 | 8 | 40 |
| | 14 | 8 | 50 | | | | |
| | 12 | 10 | 72 | | | | |

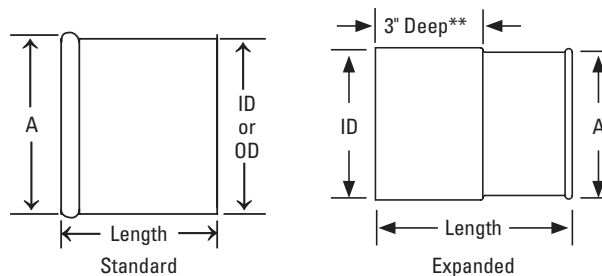

Adapters can only be expanded up to .3" above the nominal diameter size (A dimension). Expansions larger than .3" must be ordered as a reducer.

*Published lengths are nominal and may vary slightly.

Important Notice: Many factors beyond the control of Donaldson can affect the use and performance of Donaldson products in a particular application, including the conditions under which the product is used. Since these factors are uniquely within the user's knowledge and control, it is essential the user evaluate the products to determine whether the product is fit for the particular purpose and suitable for the user's application. All products, product specifications, availability and data are subject to change without notice, and may vary by region or country.

Donaldson Company, Inc.
Minneapolis, MN
donaldson.com • shop.donaldson.com

North America
Email: donaldson@donaldson.com
Phone: (USA): +1-800-365-1331 • (MX): +1-800-343-36-39

Australasia
Email: marketing.australia@donaldson.com
Phone: +61-2-4350-2000
Toll Free: (AU) +1800-345-837 • (NZ) +0800-743-387

China
Email: info.cn@donaldson.com
Phone: +86-400-820-1038

Donaldson Europe B.V.B.A.
Email: IAF-europe@donaldson.com
Phone: +32-16-38-3811

India
Email: info.difs@donaldson.com
Phone: +91-124-4807-400 • +18001035018

Japan
Email: jp-ndl.ifsw@donaldson.com
Phone: +81-42-540-4112

Korea
Email: iaf-kr@donaldson.com
Phone: +82-2-517-3333

Latinoamerica
Email: IndustrialAir@donaldson.com
Phone: +52-449-300-2442

South Africa
Email: SAMarketing@donaldson.com
Phone: +27-11-997-6000

Southeast Asia
Email: IAF.SEA@donaldson.com
Phone: +65-6311-7373

Ordering Information

- When ordering, specify material, gauge (if non-standard), dimension and end styles.
- Standard Blast Gates are cast aluminum body with galvanized blade and standard QF connection (collar), unless otherwise specified. SS model is 100% SS, body and blade are 12ga. 14ga Blast Gate is 10ga galvanized steel with a 14ga collar.

| Ø in. | Galvanized | | | | | Std Weight Lbs | Ø in. | Stainless Steel | | | | |
|-------|---------------------|---------------------|-------------|--------------------|-------|----------------|-------|---------------------|---------------------|-------------|--------------------|-------|
| | A Height Closed in. | B Height Opened in. | C Width in. | D Depth Opened in. | E in. | | | A Height Closed in. | B Height Opened in. | C Width in. | D Depth Opened in. | E in. |
| 3 | 7.50 | 8.50 | 4.25 | 5.38 | 1.63 | 1.50 | 3 | 6.50 | 9.13 | 5.00 | 5.38 | 2.75 |
| 4 | 6.75 | 9.75 | 5.13 | 5.50 | 2.25 | 2.25 | 4 | 7.75 | 11.50 | 6.00 | 5.50 | 3.00 |
| 5 | 8.00 | 11.75 | 5.88 | 5.63 | 2.63 | 3.00 | 5 | 10.50 | 14.75 | 7.00 | 5.50 | 3.50 |
| 6 | 10.00 | 14.50 | 7.00 | 5.75 | 3.00 | 3.75 | 6 | 11.13 | 16.75 | 8.00 | 5.50 | 4.00 |
| 7 | 11.13 | 15.25 | 8.00 | 5.50 | 3.75 | 4.50 | 7 | 12.13 | 18.75 | 9.00 | 5.25 | 4.50 |
| 8 | 12.00 | 12.00 | 9.25 | 5.50 | 4.25 | 5.50 | 8 | 13.63 | 21.13 | 10.00 | 5.25 | 5.00 |
| 9 | 13.38 | 13.38 | 10.50 | 5.50 | 5.13 | 7.00 | 9 | 15.13 | 24.00 | 11.00 | 5.50 | 5.50 |
| 10 | 14.50 | 23.38 | 11.25 | 5.50 | 5.25 | 7.50 | 10 | 17.13 | 26.75 | 12.00 | 5.25 | 6.00 |
| 11 | 15.25 | 25.50 | 12.25 | 5.50 | 6.00 | 9.50 | 11 | 19.13 | 28.75 | 13.00 | 5.50 | 6.50 |
| 12 | 16.25 | 27.50 | 13.25 | 5.00 | 6.88 | 13.00 | 12 | 20.38 | 32.13 | 14.00 | 5.00 | 7.00 |
| 14 | 18.63 | 30.50 | 15.50 | 5.00 | 7.63 | 16.00 | 14 | 23.25 | 36.75 | 16.00 | 5.00 | 8.00 |
| 16 | 28.50 | 43.50 | 18.00 | 11.25 | 8.88 | 21.20 | 16 | 26.25 | 40.75 | 18.00 | 5.00 | 9.00 |
| 18 | 32.50 | 32.50 | 20.00 | 11.25 | 9.88 | 25.00 | 18 | 29.25 | 44.75 | 20.00 | 5.00 | 10.00 |
| 20 | 33.88 | 33.88 | 22.25 | 11.25 | 10.50 | 30.00 | 20 | 32.25 | 48.75 | 22.00 | 5.00 | 11.00 |
| 22 | 33.50 | 33.50 | 24.25 | 11.25 | 11.13 | 34.00 | 22 | 35.25 | 52.75 | 24.00 | 5.00 | 12.00 |
| 24 | 33.38 | 33.38 | 26.25 | 11.25 | 12.25 | 38.00 | 24 | 38.25 | 56.75 | 26.00 | 5.00 | 13.00 |
| 26 | 47.50 | 70.50 | 29.25 | 11.25 | 13.25 | 62.00 | 26 | 41.25 | 60.75 | 28.00 | 5.75 | 14.00 |
| 28 | 47.50 | 73.50 | 30.25 | 11.25 | 14.25 | 72.00 | 28 | 44.25 | 64.75 | 30.00 | 5.75 | 15.00 |
| 30 | 55.75 | 82.75 | 33.25 | 11.25 | 15.25 | 97.00 | 30 | 47.25 | 68.75 | 32.00 | 5.75 | 16.00 |

**** SS Blast Gates have a production time of 7 business days minimum****

Construction
Collars: Attached to the exterior on each side of the cast aluminum body of each standard galvanized Gate. 16" and larger diameter Blast Gates have riveted-on collars. SS Blast Gates have collars fully welded to the SS body.

Optional End Styles
Standard QF end can be changed to Raw ID (RAWID), Raw OD (RAWOD), No Fitting (NF), Flat Flange (FFL), Angle Flange (AFL), or Van Stone (VANSTONE).

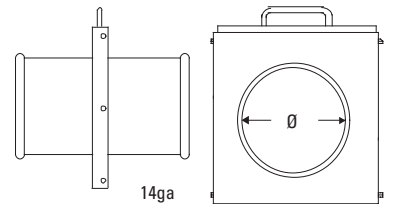
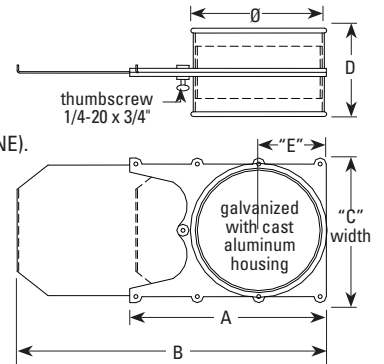
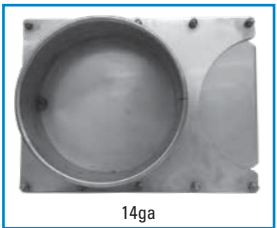
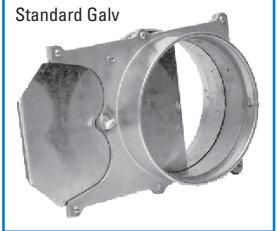

QF Material Options

| Gauges | Galv (Collar) | | Gauges | SS (Collar) | |
|----------|---------------|--------|----------|-------------|--------|
| | Min. Ø | Max. Ø | | Min. Ø | Max. Ø |
| Standard | 22 | 3 | Standard | 22 | 3 |
| | 20 | 14 | | 20 | 14 |
| Optional | 18 | 3 | Optional | 18 | 3 |
| | 16 | 8 | | 16 | 8 |
| | 14 | 8 | | 14 | 8 |

Ø SS Blast Gates have a production time of 7 days min.

Flanged Material Options

| Gauges | Galv (Collar) | | Gauges | SS (Collar) | |
|----------|---------------|--------|----------|-------------|--------|
| | Min. Ø | Max. Ø | | Min. Ø | Max. Ø |
| Standard | 22 | 3 | Standard | 22 | 3 |
| | 20 | 14 | | 20 | 14 |
| Optional | 18 | 26 | Optional | 18 | 26 |
| | 18 | 3 | | 18 | 3 |
| | 16 | 8 | | 16 | 8 |
| | 14 | 8 | | 14 | 8 |

Important Notice: Many factors beyond the control of Donaldson can affect the use and performance of Donaldson products in a particular application, including the conditions under which the product is used. Since these factors are uniquely within the user's knowledge and control, it is essential the user evaluate the products to determine whether the product is fit for the particular purpose and suitable for the user's application. All products, product specifications, availability and data are subject to change without notice, and may vary by region or country.

Donaldson Company, Inc.
Minneapolis, MN
donaldsonororit.com • shop.donaldson.com

North America
Email: donaldsonororit@donaldson.com
Phone: (USA): +1-800-365-1331 • (MX): +1-800-343-36-39

Australasia
Email: marketing.australia@donaldson.com
Phone: +61-2-4350-2000
Toll Free: (AU) +1800-345-837 • (NZ) +0800-743-387

China
Email: info.cn@donaldson.com
Phone: +86-400-820-1038

Donaldson Europe B.V.B.A.
Email: IAF-europe@donaldson.com
Phone: +32-16-38-3811

India
Email: info.difs@donaldson.com
Phone: +91-124-4807-400 • +18001035018

Japan
Email: jp-ndl.ifsw@donaldson.com
Phone: +81-42-540-4112

Korea
Email: iaf-kr@donaldson.com
Phone: +82-2-517-3333

Latinoamerica
Email: IndustrialAir@donaldson.com
Phone: +52-449-300-2442

South Africa
Email: SAMarketing@donaldson.com
Phone: +27-11-997-6000

Southeast Asia
Email: IAF.SEA@donaldson.com
Phone: +65-6311-7373

Ordering Information

- When ordering, specify material, gauge (if non-standard), dimension and end styles.
- QF clamp-together Pipe is quick and easy to install, saving time and money on installation.
- Solid welded seams prevent leakage.
- Length is nominal 5'.
- Pipe larger than 24" diameter is flanged and constructed of highly durable 16 gauge material. Flanges are industry standard angle rings.

| Ø in. | Length in. | QF Std Pipe Weight (lbs) | AFL Std Pipe Weight (lbs) | QF 14ga Pipe Weight (lbs) |
|-------|------------|--------------------------|---------------------------|---------------------------|
| 3 | 59.25 | 4.00 | 5.40 | |
| 4 | 59.25 | 5.35 | 7.05 | |
| 5 | 59.25 | 6.65 | 9.05 | |
| 6 | 59.25 | 7.93 | 10.73 | |
| 7 | 59.06 | 11.70 | 15.70 | |
| 8 | 59.06 | 13.25 | 17.75 | 36 |
| 9 | 59.06 | 14.92 | 19.92 | 40 |
| 10 | 58.75 | 16.60 | 23.10 | 44 |
| 11 | 58.75 | 18.10 | 25.10 | 49 |
| 12 | 58.75 | 19.75 | 27.75 | 53 |
| 13 | 58.75 | 21.40 | 29.90 | 57 |
| 14 | 58.75 | 27.30 | 36.80 | 61 |
| 15 | 58.75 | 29.25 | 44.25 | 66 |
| 16 | 58.75 | 31.15 | 47.15 | 70 |
| 17 | 58.75 | 33.09 | 49.59 | 74 |
| 18 | 58.75 | 34.00 | 51.00 | 79 |
| 19 | 58.75 | 36.00 | 55.00 | 83 |
| 20 | 58.75 | 38.00 | 57.00 | 87 |
| 21 | 58.75 | 40.00 | 59.5 | 92 |
| 22 | 58.75 | 42.00 | 63.50 | 96 |
| 23 | 58.75 | 44.00 | 65.5 | 100 |
| 24 | 58.75 | 45.82 | 68.82 | 104 |
| 26 | 59.00 | | 98.56 | |
| 28 | 59.00 | | 118.00 | |
| 30 | 59.00 | | 137.05 | |
| 32 | 59.00 | | 145.94 | |
| 34 | 59.00 | | 154.83 | |
| 36 | 59.00 | | 162.76 | |
| 38 | 59.00 | | 173.47 | |
| 40 | 59.00 | | 182.81 | |

QF Material Options

| Galv | | | | SS | | | |
|----------|---------------|--------|----|----------|---------------|--------|----|
| Gauges | Size (inches) | | | Gauges | Size (inches) | | |
| | Min. Ø | Max. Ø | | | Min. Ø | Max. Ø | |
| Standard | 22 | 3 | 12 | Standard | 22 | 3 | 12 |
| | 20 | 13 | 24 | | 20 | 13 | 24 |
| Optional | 18 | 4 | 24 | Optional | 18 | 8 | 24 |
| | 16 | 8 | 24 | | 16 | 8 | 24 |
| | 14 | 8 | 24 | | | | |

Flanged Material Options

| Galv (Std) | | | | SS | | | |
|------------|---------------|--------|----|----------|---------------|--------|----|
| Gauges | Size (inches) | | | Gauges | Size (inches) | | |
| | Min. Ø | Max. Ø | | | Min. Ø | Max. Ø | |
| Standard | 22 | 3 | 15 | Standard | 22 | 3 | 15 |
| | 20 | 16 | 24 | | 20 | 16 | 24 |
| | 16 | 26 | 40 | | 16 | 26 | 40 |
| Optional | 18 | 4 | 24 | Optional | 18 | 4 | 24 |
| | 16 | 8 | 24 | | 16 | 8 | 40 |
| | 14 | 8 | 50 | | | | |
| | 12 | 10 | 72 | | | | |
| | 10 | 12 | 72 | | | | |

Optional End Styles

Standard QF end can be changed to Raw ID (RAWID), Raw OD (RAWOD), No Fitting (NF), Hose Adapter (RAWFLEX), Flat Flange (FFL), Angle Flange (AFL), or Van Stone (VANSTONE). All pipe larger than 24" is flanged, rotational Angle Flange is standard. Welded flanges optional.



QF Pipe



Flanged Pipe

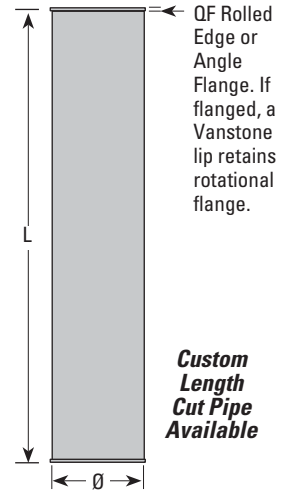

Construction

Seam: Longitudinal seam is laser or plasma welded (laser weld sizes 3" to 24" diameter, plasma weld on larger diameters).

Important Notice: Many factors beyond the control of Donaldson can affect the use and performance of Donaldson products in a particular application, including the conditions under which the product is used. Since these factors are uniquely within the user's knowledge and control, it is essential the user evaluate the products to determine whether the product is fit for the particular purpose and suitable for the user's application. All products, product specifications, availability and data are subject to change without notice, and may vary by region or country.

Donaldson Company, Inc.
Minneapolis, MN
donaldson.com • shop.donaldson.com

North America
Email: donaldson.com
Phone: (USA): +1-800-365-1331 • (MX): +1-800-343-36-39

Australasia
Email: marketing.australia@donaldson.com
Phone: +61-2-4350-2000
Toll Free: (AU) +1800-345-837 • (NZ) +0800-743-387

China
Email: info.cn@donaldson.com
Phone: +86-400-820-1038

Donaldson Europe B.V.B.A.
Email: IAF-europe@donaldson.com
Phone: +32-16-38-3811

India
Email: info.difs@donaldson.com
Phone: +91-124-4807-400 • +18001035018

Japan
Email: jp-ndl.ifsw@donaldson.com
Phone: +81-42-540-4112

Korea
Email: iaf-kr@donaldson.com
Phone: +82-2-517-3333

Latinoamerica
Email: IndustrialAir@donaldson.com
Phone: +52-449-300-2442

South Africa
Email: SAMarketing@donaldson.com
Phone: +27-11-997-6000

Southeast Asia
Email: IAF.SEA@donaldson.com
Phone: +65-6311-7373

Ordering Information

- When ordering, specify material, gauge (if non-standard), A,B dimensions and end styles.
- B end can be as small as 1".

14 Gauge Reducers:

- Any Reducer with B end smaller than 8" will be hybrid. Smaller section will be a lighter gauge.

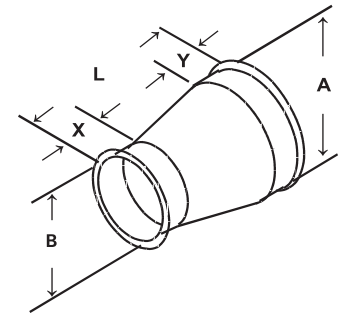

| AØ (in.) | Length (in.) | Weight (lbs) |
|----------|--------------|--------------|
| 3 | | 1.00 |
| 4 | | 1.25 |
| 5 | | 1.50 |
| 6 | | 1.75 |
| 7 | | 2.00 |
| 8 | | 2.25 |
| 9 | | 2.50 |
| 10 | | 3.00 |
| 11 | | 3.50 |
| 12 | | 3.75 |
| 13 | | 4.00 |
| 14 | | 4.50 |
| 15 | | 6.00 |
| 16 | | 7.00 |
| 17 | | 10.25 |
| 18 | | 21.00 |
| 19 | | 25.00 |
| 20 | | 30.00 |
| 21 | | 35.00 |
| 22 | | 39.50 |
| 23 | | 47.00 |
| 24 | | 53.50 |
| 26 | | 74.00 |
| 28 | | 98.00 |
| 30 | | 117.05 |
| 32 | | 125.94 |
| 34 | | 134.83 |
| 36 | | 142.78 |
| 38 | | 153.47 |
| 40 | | 162.81 |

| A-B Δ | Formula |
|-------|---------|
| 1-6 | A-B+6 |
| 7-12 | A-B+8 |
| 13+ | A-B+10 |

Ex: A=8" B=6" Reducer, A-B= 2, therefore Δ=2, so you will use the first formula since the difference is between 1-6 A-B+6= 8" Length

| A-B Δ | Formula |
|-------|---------|
| 1-6 | A-B+7 |
| 7-12 | A-B+9 |
| 13+ | A-B+11 |

Ex: A=36" B=28" Reducer, A-B= 8, therefore Δ=8, so you will use the second formula since the difference is between 7-12 A-B+9= 17" Length

QF Material Options

| Galv | | | | SS | | | |
|----------|---------------|--------|--------|---------------|--------|----|----|
| Gauges | Size (inches) | | Gauges | Size (inches) | | | |
| | Min. Ø | Max. Ø | | Min. Ø | Max. Ø | | |
| Standard | 22 | 3 | 12 | Standard | 22 | 3 | 12 |
| | 20 | 13 | 24 | | 20 | 13 | 24 |
| Optional | 18 | 26 | 40 | Optional | 18 | 26 | 40 |
| | 16 | 8 | 24 | | 16 | 8 | 24 |

Flanged Material Options

| Galv (Std) | | | | SS | | | |
|------------|---------------|--------|--------|---------------|--------|----|----|
| Gauges | Size (inches) | | Gauges | Size (inches) | | | |
| | Min. Ø | Max. Ø | | Min. Ø | Max. Ø | | |
| Standard | 22 | 3 | 15 | Standard | 22 | 3 | 15 |
| | 20 | 16 | 40 | | 20 | 16 | 40 |
| Optional | 18 | 26 | 40 | Optional | 18 | 26 | 40 |
| | 16 | 8 | 40 | | 16 | 8 | 40 |
| | 14 | 8 | 50 | | | | |
| | 12 | 10 | 72 | | | | |

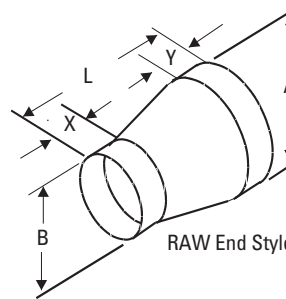
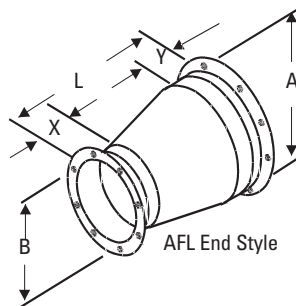

Construction

Seam: longitudinal seam is lapped, spot welded, and caulked.
Collars: located on the exterior side of each port and considered as air flow non-directional. Collars have a laser welded longitudinal seam. If air flow directional product is required, it must be stated on the PO and additional cost may be incurred. A raised lap seam and spot weld are used for attaching the collar to the body and no caulking is used. If caulking is required, additional cost may be incurred.

Optional End Styles

Standard QF end can be changed to Raw ID (RAWID), Raw OD (RAWOD), No Fitting (NF), Hose Adapter (RAWFLEX) only on sizes 3" and above, Flat Flange (FLL), Angle Flange (AFL), or Van Stone (VANSTONE). Any combination of the above end styles are available upon request.

Important Notice: Many factors beyond the control of Donaldson can affect the use and performance of Donaldson products in a particular application, including the conditions under which the product is used. Since these factors are uniquely within the user's knowledge and control, it is essential the user evaluate the products to determine whether the product is fit for the particular purpose and suitable for the user's application. All products, product specifications, availability and data are subject to change without notice, and may vary by region or country.

Donaldson Company, Inc.
 Minneapolis, MN
donaldson.com • shop.donaldson.com

North America
 Email: donaldson@donaldson.com
 Phone: (USA): +1-800-365-1331 • (MX): +1-800-343-36-39

Australasia
 Email: marketing.australia@donaldson.com
 Phone: +61-2-4350-2000
 Toll Free: (AU) +1800-345-837 • (NZ) +0800-743-387

China
 Email: info.cn@donaldson.com
 Phone: +86-400-820-1038

Donaldson Europe B.V.B.A.
 Email: IAF-europe@donaldson.com
 Phone: +32-16-38-3811

India
 Email: info.difs@donaldson.com
 Phone: +91-124-4807-400 • +18001035018

Japan
 Email: jp-ndi.ifsw@donaldson.com
 Phone: +81-42-540-4112

Korea
 Email: iaf-kr@donaldson.com
 Phone: +82-2-517-3333

Latinoamerica
 Email: IndustrialAir@donaldson.com
 Phone: +52-449-300-2442

South Africa
 Email: SAMarketing@donaldson.com
 Phone: +27-11-997-6000

Southeast Asia
 Email: IAF.SEA@donaldson.com
 Phone: +65-6311-7373

Ordering Information

- When ordering, specify material (galvanized or Stainless Steel), size dimension, end style(s), and length. Supplied in 5' increments.
- Flexible rigid steel hose for higher temperature or abrasive material.
- 1.5" - 6" is sold in 5' increments up to a 25' maximum length. 7" - 14" hoses are sold in 5' increments only. If lengths longer than 5' are needed, Nordfab can supply 5' hose assemblies with Quick-Fit ends to easily connect additional assemblies.
- Raw ends standard. QF or Angle Flange ends can be attached (additional charge).



| Size in. | ID in. | Approx. Outside Dia* in. | CL Bend Radius in. | Approx Weight per foot lbs |
|----------|--------|--------------------------|--------------------|----------------------------|
| 1.5 | 1.125 | 1.75 | 6.375 | 1.00 |
| 2 | 2.000 | 2.25 | 9.00 | 1.30 |
| 2.5 | 2.3125 | 2.75 | 10.25 | 1.60 |
| 3 | 3.0625 | 3.25 | 12.50 | 2.00 |
| 4 | 4.000 | 4.25 | 16.25 | 2.60 |
| 5 | 5.000 | 5.25 | 19.50 | 3.00 |
| 6 | 6.000 | 6.25 | 25.00 | 3.60 |
| 7 | 7.250 | 7.25 | 27.50 | 4.00 |
| 8 | 8.125 | 8.25 | 32.00 | 4.60 |
| 9 | 9.125 | 9.25 | 34.00 | 5.30 |
| 10 | 9.750 | 10.25 | 37.50 | 5.90 |
| 12 | 12.000 | 12.25 | 44.00 | 7.00 |
| 14 | 14.000 | 14.25 | 53.00 | 8.10 |

◇ Items may take longer than standard lead times.

Do **NOT** use standard SS Hose Clamps with these hoses.



Temperature Rating:
Galvanized Steel max. 390° F / Stainless Steel max. 1500° F

Optional End Styles

Standard raw end can be changed to Raw ID, Raw OD, No fitting, Hose Adapter, Flat Flange, or QF (additional cost for hose assembly).

*OD varies depending on how hose is wound

Important Notice: Many factors beyond the control of Donaldson can affect the use and performance of Donaldson products in a particular application, including the conditions under which the product is used. Since these factors are uniquely within the user's knowledge and control, it is essential the user evaluate the products to determine whether the product is fit for the particular purpose and suitable for the user's application. All products, product specifications, availability and data are subject to change without notice, and may vary by region or country.

Donaldson Company, Inc.
Minneapolis, MN
donaldson.com • shop.donaldson.com

North America
Email: donaldson@donaldson.com
Phone: (USA): +1-800-365-1331 • (MX): +1-800-343-36-39

Australasia
Email: marketing.australia@donaldson.com
Phone: +61-2-4350-2000
Toll Free: (AU) +1800-345-837 • (NZ) +0800-743-387

China
Email: info.cn@donaldson.com
Phone: +86-400-820-1038

Donaldson Europe B.V.B.A.
Email: IAF-europe@donaldson.com
Phone: +32-16-38-3811

India
Email: info.difs@donaldson.com
Phone: +91-124-4807-400 • +18001035018

Japan
Email: jp-ndl.ifsweb@donaldson.com
Phone: +81-42-540-4112

Korea
Email: iaf-kr@donaldson.com
Phone: +82-2-517-3333

Latinoamerica
Email: IndustrialAir@donaldson.com
Phone: +52-449-300-2442

South Africa
Email: SAMarketing@donaldson.com
Phone: +27-11-997-6000

Southeast Asia
Email: IAF.SEA@donaldson.com
Phone: +65-6311-7373

Ordering Information

- When ordering, specify Black or Clear, dimension, and overall length. Supplied in 5' increments, ex. 5', 10', 15'.
- Black is thermoplastic flexible rubber hose reinforced with spring steel wire helix. 1" - 12" is sold in 5' increments up to 50' maximum. 14" - 24" sold in 5' increments up to 25' maximum.
- Clear is polyurethane flexible rubber hose reinforced with a bronze coated spring steel wire helix, manufactured with FDA acceptable materials. 2" - 12" is sold in 5' increments up to 50' maximum. 14" - 16" sold in 5' increments up to 25' maximum.
- Order Hose or Bridge Clamps separately.
- The Hose Adapter can be used with this Hose.

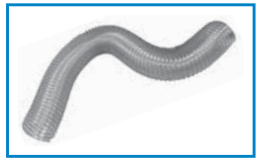

| Black Hose | | | | | | |
|--------------|--------------------|--------------------|-----------------------|--------------------------|----------------------|----------------------|
| Inside Ø in. | Wall Thickness in. | CL Bend Radius in. | Compression Ratio in. | Negative Pressure in./hg | Working Pressure PSI | Approx Weight lbs/hr |
| 1 | N/A | N/A | N/A | N/A | N/A | .14 |
| 1.5 | .025 | 1.7 | 2:1 | 29 | 25 | .17 |
| 2 | | 2 | 2:1 | 29 | 19 | .24 |
| 2.5 | .030 | 2.5 | 2:1 | 29 | 14 | .27 |
| 80mm | | 3 | 2:1 | 29 | 11 | .34 |
| 4 | | 4 | 2:1 | 29 | 10 | .39 |
| 5 | | 5.5 | 2:1 | 29 | 9 | .50 |
| 5.5 | | 6.5 | 2:1 | 17 | 8 | .64 |
| 6 | | 6.8 | 2:1 | 12.5 | 7 | .71 |
| 7 | | 6 | 3:1 | 11 | 7 | .91 |
| 8 | | 7 | 3:1 | 9 | 5 | 1.00 |
| 9 | | 8 | 3:1 | 5.5 | 4.5 | 1.04 |
| 10 | | 9 | 3:1 | 10 | 4 | 1.20 |
| 12 | | 10 | 3:1 | 6.5 | 4 | 1.60 |
| 14 | | 12 | 3:1 | 5 | 3.8 | 2.00 |
| 16 | | 14 | 3:1 | 3 | 3.2 | 2.40 |
| 18 | | 16 | 3:1 | 2.3 | 2.6 | 2.80 |
| 20 | | 18 | 3:1 | 2 | 2.3 | 3.60 |
| 22 | | 21 | 3:1 | 1.5 | 2 | 4.00 |
| 24 | | 25 | 3:1 | .8 | 1.75 | 6.00 |



Temperature Rating: Black Hose: -65° to 275°
Clear Hose: -65° to 225°

Technical data based on 2 ft. straight lengths of hose @ 72°

| Clear Hose | | | | | | |
|--------------|--------------------|--------------------|-----------------------|--------------------------|----------------------|----------------------|
| Inside Ø in. | Wall Thickness in. | CL Bend Radius in. | Compression Ratio in. | Negative Pressure in./hg | Working Pressure PSI | Approx Weight lbs/hr |
| 2 | .015 | 2.00 | 3:1 | 29.0 | 30.0 | .25 |
| 2.5 | .020 | 2.75 | 4:1 | 19.0 | 30.0 | .35 |
| 80mm | | 3.25 | 4:1 | 29.0 | 30.0 | .40 |
| 4 | | 3.75 | 4:1 | 24.0 | 22.0 | .50 |
| 5 | | 4.50 | 4:1 | 13.0 | 18.0 | .60 |
| 6 | | 5.25 | 4:1 | 8.0 | 15.0 | .70 |
| 7 | | 5.88 | 5:1 | 8.0 | 10.0 | .80 |
| 8 | | 6.50 | 5:1 | 2.0 | 7.0 | .90 |
| 9 | | N/A | 5:1 | N/A | N/A | N/A |
| 10 | | 7.50 | 5:1 | 2.0 | 7.0 | 1.20 |
| 12 | | 9.00 | 5:1 | 1.7 | 6.0 | 1.40 |
| 14 | | 12.00 | 5:1 | 1.1 | 5.0 | 1.60 |
| 16 | | 14.00 | 5:1 | 7.0 | 4.6 | 1.80 |

Important Notice: Many factors beyond the control of Donaldson can affect the use and performance of Donaldson products in a particular application, including the conditions under which the product is used. Since these factors are uniquely within the user's knowledge and control, it is essential the user evaluate the products to determine whether the product is fit for the particular purpose and suitable for the user's application. All products, product specifications, availability and data are subject to change without notice, and may vary by region or country.

Donaldson Company, Inc.
Minneapolis, MN
donaldsontorit.com • shop.donaldson.com

North America
Email: donaldsontorit@donaldson.com
Phone: (USA): +1-800-365-1331 • (MX): +1-800-343-36-39

Australasia
Email: marketing.australia@donaldson.com
Phone: +61-2-4350-2000
Toll Free: (AU) +1800-345-837 • (NZ) +0800-743-387

China
Email: info.cn@donaldson.com
Phone: +86-400-820-1038

Donaldson Europe B.V.B.A.
Email: IAF-europe@donaldson.com
Phone: +32-16-38-3811

India
Email: info.difs@donaldson.com
Phone: +91-124-4807-400 • +18001035018

Japan
Email: jp-ndl.ifsw@donaldson.com
Phone: +81-42-540-4112

Korea
Email: iaf-kr@donaldson.com
Phone: +82-2-517-3333

Latinoamerica
Email: IndustrialAir@donaldson.com
Phone: +52-449-300-2442

South Africa
Email: SAMarketing@donaldson.com
Phone: +27-11-997-6000

Southeast Asia
Email: IAF-SEA@donaldson.com
Phone: +65-6311-7373

Ordering Information

- Used to provide variable length adjustment of QF System. Each QF pipe section is 5 ft. in length. To accommodate an existing span of less than 5', a sleeve is used to shorten. Formerly known as Adjustable Nipple
- Solid welded seams prevent leakage.
- Nitrile (black) O-ring included standard.
- Specify Silicone (red) O-ring (high temp rating) if needed (additional cost). Replace on-site.

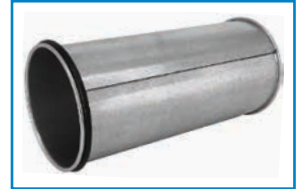

| Ø in. | Length in. | Weight (lbs) |
|-------|------------|--------------|
| 3 | 11.25 | 0.80 |
| 4 | 11.375 | 1.05 |
| 5 | 11.375 | 1.30 |
| 6 | 11.375 | 1.6 |
| 7 | 11.125 | 2.4 |
| 8 | 11.125 | 2.7 |
| 9 | 11.125 | 3.05 |
| 10 | 11.125 | 3.4 |
| 11 | 11.125 | 3.8 |
| 12 | 10.875 | 4.2 |
| 13 | 10.875 | 4.7 |
| 14 | 10.875 | 5.85 |
| 15 | 10.875 | 6.25 |
| 16 | 10.875 | 6.65 |
| 17 | 10.875 | 7.45 |
| 18 | 10.875 | 7.45 |
| 19 | 10.875 | 8.1 |
| 20 | 10.875 | 8.8 |
| 21 | 10.875 | 9.7 |
| 22 | 10.875 | 8.1 |
| 23 | 10.875 | 8.8 |
| 24 | 10.875 | 9.7 |

QF Material Options

| Galv | | | |
|----------|---------------|--------|----|
| Gauges | Size (inches) | | |
| | Min. Ø | Max. Ø | |
| Standard | 22 | 3 | 12 |
| | 20 | 13 | 24 |
| Optional | 18 | 4 | 24 |

| SS | | | |
|----------|---------------|--------|----|
| Gauges | Size (inches) | | |
| | Min. Ø | Max. Ø | |
| Standard | 22 | 3 | 12 |
| | 20 | 13 | 24 |
| Optional | 18 | 4 | 24 |

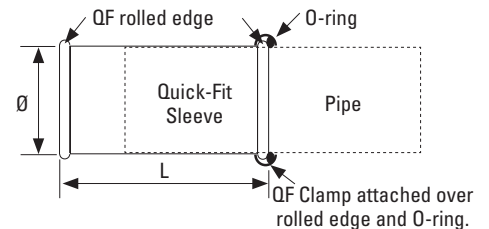

The Quick-Fit Sleeve provides an easy way to adjust for straight duct sections shorter than 5'



1 Measure distance to be spanned.



2 On a Pipe, mark distance to be spanned less 4".



3 Use provided O-ring to mark for cut.



4 Drill access hole, then cut Pipe with saw.

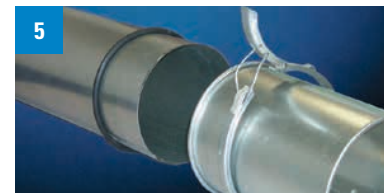

5 Place O-ring on the cut pipe and slide a Quick-Fit Sleeve over the cut piece.



6 Snap QF Clamp over O-ring and one end of Quick-Fit Sleeve.



Finished connection with the Quick-Fit Sleeve

NOTE: KEEP CUT PIPE IN THE SAME DIRECTION AS THE AIRFLOW.

Construction
Seam: Longitudinal seam is laser welded.

Important Notice: Many factors beyond the control of Donaldson can affect the use and performance of Donaldson products in a particular application, including the conditions under which the product is used. Since these factors are uniquely within the user's knowledge and control, it is essential the user evaluate the products to determine whether the product is fit for the particular purpose and suitable for the user's application. All products, product specifications, availability and data are subject to change without notice, and may vary by region or country.

Donaldson Company, Inc.
Minneapolis, MN
donaldson.com • shop.donaldson.com

North America
Email: donaldson@donaldson.com
Phone: (USA): +1-800-365-1331 • (MX): +1-800-343-36-39

Australasia
Email: marketing.australia@donaldson.com
Phone: +61-2-4350-2000
Toll Free: (AU) +1800-345-837 • (NZ) +0800-743-387

China
Email: info.cn@donaldson.com
Phone: +86-400-820-1038

Donaldson Europe B.V.B.A.
Email: IAF-europe@donaldson.com
Phone: +32-16-38-3811

India
Email: info.difs@donaldson.com
Phone: +91-124-4807-400 • +18001035018

Japan
Email: jp-ndl.ifsw@donaldson.com
Phone: +81-42-540-4112

Korea
Email: iaf-kr@donaldson.com
Phone: +82-2-517-3333

Latinoamerica
Email: IndustrialAir@donaldson.com
Phone: +52-449-300-2442

South Africa
Email: SAMarketing@donaldson.com
Phone: +27-11-997-6000

Southeast Asia
Email: IAF-SEA@donaldson.com
Phone: +65-6311-7373



EASY DUCT™ ULTRA FLEX STEEL HOSE

Ordering Information

- When ordering, specify material (galvanized or Stainless Steel), size dimension, end style(s), and length. Supplied in 5' increments.
- Flexible steel hose for higher temperature or abrasive material.
- 3" - 6" is sold in 5' increments up to a 25' maximum length. 7" - 8" hoses are sold in 5' increments only. If lengths longer than 5' are needed, Nordfab can supply 5' hose assemblies with Quick-Fit ends to easily connect additional assemblies.
- Plain ends standard. QF or Angle Flange ends can be attached (additional charge).

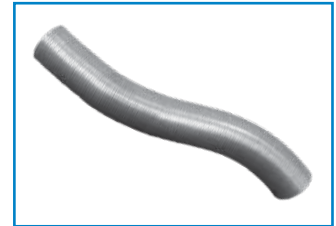

| Size in. | ID in. | Approx. Outside Dia* in. | Approx. Weight per foot lbs |
|----------|--------|--------------------------|-----------------------------|
| 3 | 3.036 | 3.125 | 2.15 |
| 4 | 4.063 | 4.250 | 2.65 |
| 5 | 5.125 | 5.250 | 2.95 |
| 6 | 6.063 | 6.188 | 3.55 |
| 7 | 7.000 | 7.250 | 4.15 |
| 8 | 8.125 | 8.250 | 4.55 |

◊ Items may take longer than standard lead times.

Do NOT use standard SS Hose Clamps with these hoses.



Temperature Rating: Galvanized Steel max. 390° F / Stainless Steel max. 1500° F

Optional End Styles

Standard raw end can be changed to Raw ID, Raw OD, No fitting, Hose Adapter, Flat Flange, or QF (additional cost for hose assembly).

*OD varies depending on how hose is wound Square lock:
ID Tolerance +1/4", -0

Important Notice: Many factors beyond the control of Donaldson can affect the use and performance of Donaldson products in a particular application, including the conditions under which the product is used. Since these factors are uniquely within the user's knowledge and control, it is essential the user evaluate the products to determine whether the product is fit for the particular purpose and suitable for the user's application. All products, product specifications, availability and data are subject to change without notice, and may vary by region or country.

Donaldson Company, Inc.
Minneapolis, MN
donaldson.com • shop.donaldson.com

North America
Email: donaldson@donaldson.com
Phone: (USA): +1-800-365-1331 • (MX): +1-800-343-36-39

Australasia
Email: marketing.australia@donaldson.com
Phone: +61-2-4350-2000
Toll Free: (AU) +1800-345-837 • (NZ) +0800-743-387

China
Email: info.cn@donaldson.com
Phone: +86-400-820-1038

Donaldson Europe B.V.B.A.
Email: IAF-europe@donaldson.com
Phone: +32-16-38-3811

India
Email: info.difs@donaldson.com
Phone: +91-124-4807-400 • +18001035018

Japan
Email: jp-ndl.ifsw@donaldson.com
Phone: +81-42-540-4112

Korea
Email: iaf-kr@donaldson.com
Phone: +82-2-517-3333

Latinoamerica
Email: IndustrialAir@donaldson.com
Phone: +52-449-300-2442

South Africa
Email: SAMarketing@donaldson.com
Phone: +27-11-997-6000

Southeast Asia
Email: IAF-SEA@donaldson.com
Phone: +65-6311-7373

Ordering Information

- When ordering, specify material, gauge (if non-standard), dimensions A, B, C, end styles, and angle (standard 60°, optional 90°).
- Both B & C each must be at least 50% of A, with B or C being at least 80% of the opposite leg.
- Flange Leg: Length = 4.5" Height = A + 4"
- 14 Gauge Y Branches:
 - Any Branch with B, or C end smaller than 8" will be hybrid. (Smaller section will be a lighter gauge.)



| A Ø in. | Length in. | Weight Lbs |
|---------|-------------------------|------------|
| 3 | QF or Raw ends: | 1.50 |
| 4 | To manufacture, | 1.75 |
| 5 | B and C must be 50% | 2.00 |
| 6 | or greater of A; | 2.75 |
| 7 | B and C must be | 3.25 |
| 8 | within 80% of each | 4.50 |
| 9 | other. Example: if | 5.25 |
| 10 | B=10", then C must be | 6.75 |
| 11 | at least 8" or greater. | 8.00 |
| 12 | Length = A + 4" | 10.25 |
| 13 | 14ga QF or Raw ends: | 12.50 |
| 14 | To manufacture, | 14.00 |
| 15 | B and C must be | 15.75 |
| 16 | 50% or greater of A; | 17.00 |
| 17 | B and C must be | 18.50 |
| 18 | within 80% of each | 20.00 |
| 19 | other. Example: | 24.50 |
| 20 | if B=15", then C | 29.00 |
| 21 | must be at least | 36.00 |
| 22 | 12" or greater. | 39.50 |
| 23 | Length = A + 4" | 47.00 |
| 24 | | 53.50 |
| 25 | | 58.00 |
| 26 | | 69.00 |
| 27 | | 78.00 |
| 28 | Angle Flange or | 93.00 |
| 29 | Flat Flange ends: | 107.00 |
| 30 | Flanged ends: | 112.05 |
| 31 | B or C ports leg | 115.00 |
| 32 | length is 4.5" min. | 120.94 |
| 33 | 14ga or 12ga with | 124.00 |
| 34 | Flanged ends: | 129.83 |
| 35 | B or C ports leg | 133.00 |
| 36 | length is 1/2 | 137.78 |
| 37 | greater of B or C | 143.00 |
| 38 | | 148.47 |
| 39 | | 152.00 |
| 40 | | 157.81 |

QF Material Options

| Galv | | | | SS | | | |
|----------|---------------|--------|--------|---------------|--------|----|--|
| Gauges | Size (inches) | | Gauges | Size (inches) | | | |
| | Min. Ø | Max. Ø | | Min. Ø | Max. Ø | | |
| Standard | 22 | 3 | 12 | 22 | 3 | 12 | |
| | 20 | 13 | 24 | 20 | 13 | 24 | |
| Optional | 16 | 8 | 24 | 18 | 8 | 24 | |
| | 14 | 8 | 24 | 16 | 8 | 24 | |

Flanged Material Options

| Galv (Std) | | | | SS | | | |
|------------|---------------|--------|--------|---------------|--------|----|----|
| Gauges | Size (inches) | | Gauges | Size (inches) | | | |
| | Min. Ø | Max. Ø | | Min. Ø | Max. Ø | | |
| Standard | 22 | 3 | 15 | 22 | 3 | 15 | |
| | 20 | 16 | 40 | 20 | 16 | 40 | |
| Optional | 18 | 26 | 40 | Optional | 18 | 26 | 40 |
| | 16 | 8 | 40 | | 16 | 8 | 40 |
| | 14 | 8 | 50 | | | | |
| | 12 | 10 | 72 | | | | |
| | 10 | 12 | 72 | | | | |

Optional End Styles

Standard QF end can be changed to
Raw ID (RAWID),
Raw OD (RAWOD),
No Fitting (NF),
Hose Adapter (RAWFLEX),
Flat Flange (FFL),
Angle Flange (AFL), or
Van Stone (VANSTONE).

Collars: Located on the exterior side of each port and considered as air flow non-directional. Collars have a laser welded longitudinal seam. If airflow directional product is required, it must be stated on the PO and additional cost may be incurred. A raised lap seam and spot weld are used for attaching the collar to the body and no caulking is used. If caulking is required, additional cost may be incurred.
14ga and 12ga - Collars have a plasma welded longitudinal seam.

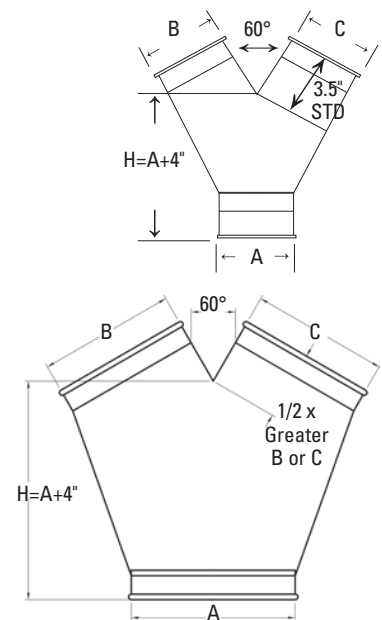

Please carefully note
Y Branch End Label
designations (ABC)

Construction: Seam: Longitudinal seam is lapped, spot welded, and caulked on standard gauges. 14ga and 12ga - Solid butt welds.

Important Notice: Many factors beyond the control of Donaldson can affect the use and performance of Donaldson products in a particular application, including the conditions under which the product is used. Since these factors are uniquely within the user's knowledge and control, it is essential the user evaluate the products to determine whether the product is fit for the particular purpose and suitable for the user's application. All products, product specifications, availability and data are subject to change without notice, and may vary by region or country.

Donaldson Company, Inc.
Minneapolis, MN
donaldsontorit.com • shop.donaldson.com

North America
Email: donaldsontorit@donaldson.com
Phone: (USA): +1-800-365-1331 • (MX): +1-800-343-36-39

Australasia
Email: marketing.australia@donaldson.com
Phone: +61-2-4350-2000
Toll Free: (AU) +1800-345-837 • (NZ) +0800-743-387

China
Email: info.cn@donaldson.com
Phone: +86-400-820-1038

Donaldson Europe B.V.B.A.
Email: IAF-europe@donaldson.com
Phone: +32-16-38-3811

India
Email: info.difs@donaldson.com
Phone: +91-124-4807-400 • +18001035018

Japan
Email: jp-ndl.ifswb@donaldson.com
Phone: +81-42-540-4112

Korea
Email: iaf-kr@donaldson.com
Phone: +82-2-517-3333

Latinoamerica
Email: IndustrialAir@donaldson.com
Phone: +52-449-300-2442

South Africa
Email: SAMarketing@donaldson.com
Phone: +27-11-997-6000

Southeast Asia
Email: IAF.SEA@donaldson.com
Phone: +65-6311-7373

Industry-Leading Technology

- Advanced filtration technology for optimal performance
- Reduced energy consumption and cost of ownership
- Advanced design and testing capabilities

The Most Filters and Parts

- For every brand and style of collector
- Wide range of filtration media for any application
- 90,000 filters and parts in stock and ready to ship

Unparalleled Support

- Live technical specialists
- Comprehensive pre- and post-sale support
- 40 manufacturing plants and 14 distribution centers worldwide

Call Donaldson® Torit® to get cleaner air today:

800-365-1331

DonaldsonTorit.com

Important Notice

Many factors beyond the control of Donaldson can affect the use and performance of Donaldson products in a particular application, including the conditions under which the product is used. Since these factors are uniquely within the user's knowledge and control, it is essential the user evaluate the products to determine whether the product is fit for the particular purpose and suitable for the user's application. All products, product specifications, availability and data are subject to change without notice, and may vary by region or country.



Donaldson.

Donaldson Company, Inc.
Minneapolis, MN
donaldson.com • shop.donaldson.com

North America
Email: donaldson@donaldson.com
Phone: (USA): +1-800-365-1331
(MX): +1-800-343-36-39

Australasia
Email: marketing.australia@donaldson.com
Phone: +61-2-4350-2000
Toll Free: (AU) +1800-345-837
(NZ) +0800-743-387

China
Email: info.cn@donaldson.com
Phone: +86-400-820-1038

Donaldson Europe B.V.B.A.
Email: IAF-europe@donaldson.com
Phone: +32-16-38-3811

India
Email: info.difs@donaldson.com
Phone: +91-124-4807-400 • +18001035018

Japan
Email: jp-ndl.ifsweb@donaldson.com
Phone: +81-42-540-4112

04/20 Easy-Duct Product Sheets ©2019-2020 Donaldson Company, Inc. Donaldson, Torit, Easy-Duct and the color blue are marks of Donaldson Company, Inc. All other marks belong to their respective owners.

Korea
Email: iaf-kr@donaldson.com
Phone: +82-2-517-3333

Latinoamerica
Email: IndustrialAir@donaldson.com
Phone: +52-449-300-2442

South Africa
Email: SAMarketing@donaldson.com
Phone: +27-11-997-6000

Southeast Asia
Email: IAF.SEA@donaldson.com
Phone: +65-6311-7373