



Level 3+ Retrofit Emission Solutions for Coach & Transit Buses

Coach/Transit kits for Pre-2007 Buses



Proven Reliability

Vehicle Manufactures	Vehicle Model	----- Carb -Level 3+ -----	
		1998-2006 LNF Muffler (for High NOx)	1991-2003 LXF Muffler (for Lox NOx)
		Part Number	
MCI	D4500, 4505, 4000	X009960	X010802
	J4500, E4500	-	X010805
	102DL3	X009962	-
Van Hool	C2045	X009966	X010808
Nova	LFS	-	X010810
	RTS	X009967	-
New Flyer	Artic	X009970	X010812
Setra		-	X010813
Gillig	3116, 3126	X009972	-

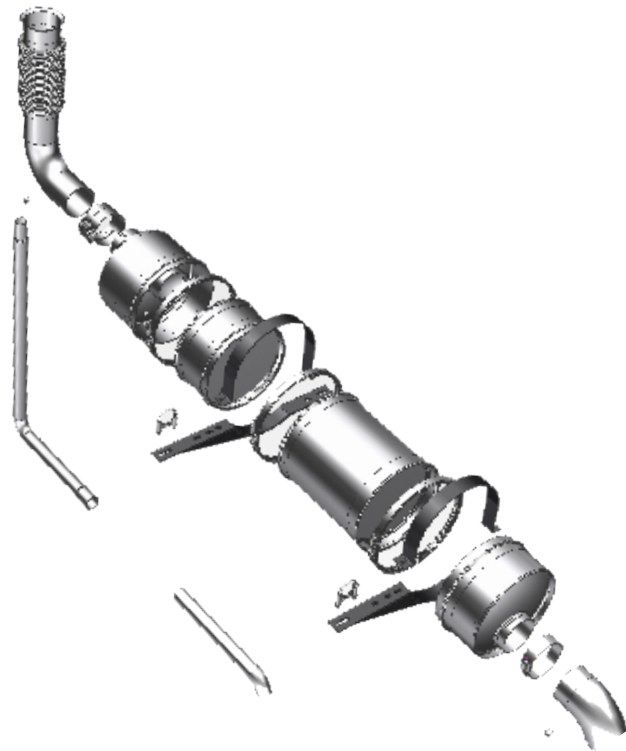

MCI Kit: X009960

Any muffler kit installation must correspond with the Donaldson Approval Letter communicated to our certified Emissions Dealer.

Donaldson Company, Inc.
PO Box 1299
Minneapolis, MN
55440-1299

www.donaldson.com
www.donaldson.com/emissions

North America
Sales: 866-675-2847
Email: emissionssales@donaldson.com

Technical Support: 866-617-8733
Email: emissions@donaldson.com

Brochure No. F111399 ENG (10/12)
© 2012 Donaldson Company, Inc. All rights reserved. Printed in the U.S.A. Donaldson Company, Inc. reserves the right to change or discontinue any model or specification at any time and without notice.